

TELEFUNKEN

10KG FRONT LOAD WASHER WITH STEAM ASSIST

TF100AUFL8

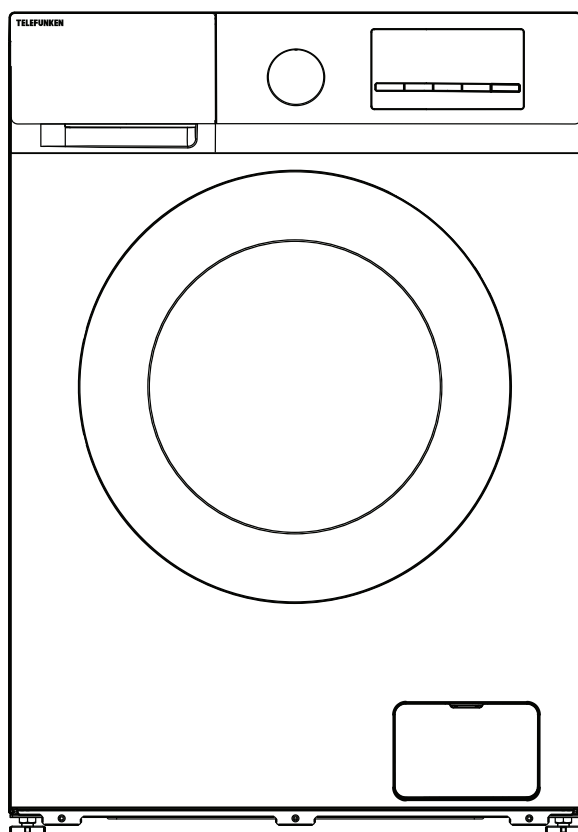

INSTRUCTION MANUAL

Please read this manual carefully before using, and keep it for future reference.

CONTENTS

General Safety Instructions	4
Product Overview	8
Installation Instructions	9
Operating the Washing Machine	15
Maintenance	24
Troubleshooting	27
Fabric Care Label	29
Specifications	30
Customer Helpline	Last Page

GENERAL SAFETY INSTRUCTIONS

IMPORTANT INFORMATION

Read this manual thoroughly before you start using the Front Load Washing Machine.

The safety precautions instructions reduces the risk of fire, electric shock and injury when correctly complied to.

Please follow all instructions and take notice of all warnings.

Pay close attention to messages that follow this safety alert symbol or the words **DANGER**, **WARNING** or **CAUTION**. These words will be used to alert you of potential hazards that and injure you and others. Following these instruction will tell you how to reduce the chance of injury and the possible dangers if instructions aren't followed.



WARNING

This symbol indicates when there is a serious risk of injury if you do not pay attention to the warnings.



CAUTION

This symbol indicates when to be careful to avoid a serious risk of injury to oneself or damage to property.

GENERAL SAFETY INSTRUCTIONS (cont.)

ELECTRICAL SAFETY

- **Voltage:** Plug the appliance to a 220-240V, 50Hz, properly earthed power outlet, it must be in good working order.
- **Power connection:** Do not use an adaptor or an extension cord. Plug the power plug directly into a separate power point that cannot be accidentally turned off, and that is easily accessible so you can switch it off if needed.
- **Power cord:** Do not kink or damage the power supply cord. Make sure it is behind the appliance so no one can step on or place anything on the power supply cord or against it. A damaged power plug may overheat and cause a fire.
- **Damaged cord:** Do not use a cord that shows cracks or damage. Any damage to the cord may cause a short circuit, fire and/or electric shock. Contact our support centre on info@ayonz.com for advice
- **Disconnection:** Never pull the power cord to unplug appliance. Grip the plug and pull straight out from the power point.
- **Electrical work:** If the installation of this appliance requires any electrical work, make sure it is carried out by an electrician.

To reduce risk of fire, electric shock or injury, always follow these basic precautions and accident prevention measures when using this appliance, including the below:

NOTE: This appliance should be installed by an authorised technician else warranty will be void.

INSTALLATION

- The product is heavy, be careful when moving it. To avoid back or other injury, have 2 people lift or mechanical aid when installing.
- When unboxing, thoroughly inspect the appliance carefully for any damage. If there is any damage, do not install the appliance. Contact our support centre on info@ayonz.com for advice.
- While installing the appliance make sure that the power cord is not bent or flattened.
- Make sure to remove all packaging materials such as foams and tapes before installing the appliance.
- Make sure if the machine is to be placed on carpet that the ventilation openings in the base are not obstructed
- Install the washing machine on a flat level and stable ground.

GENERAL SAFETY INSTRUCTIONS (Cont.)

USAGE CONDITIONS AND RESTRICTIONS

- Supervision over children is to ensure that they do not play with the appliance. Never allow them to use, play with or crawl inside the appliance. Cleaning and maintenance must not be done by children.
- This appliance is not to be used by persons (including children) with reduced physical, sensory or mental capabilities, or lack of experience and knowledge, unless they are being supervised or been given instructions on how to use of the appliance in a safe way and understand the hazards with using this appliance incorrectly.
- Only for indoor domestic use only. It is not to be used for industrial or commercial use.
- Do not use this product for anything other than its intended purpose, and only use it as described in this manual. Do not attempt to alter or modify this appliance.
- In the process of a hot wash, the door window can become hot. Make sure not to touch it or that no children or pets come into contact with the door window.
- Ensure that emptying all pockets of every item to make sure that there is no hard, sharp objects such as coins, safety pins, bra wires, nails or screws can cause damage to the appliance and has a chance to block the pump.
- Damage or malfunction caused from foreign objects is not covered by your warranty to the appliance.
- Do not operate this appliance outdoors.
- Incorrect use can result in property damage, injury or death. We assume no liability for misuse of the appliance or noncompliance with these instructions.
- Maximum load of dry clothes is 8kg
- This appliance is intended to be used in household and similar applications such as:
 - staff kitchen areas in shops, offices and other working environments;
 - farm houses;
 - by clients in hotels, motels and other residential type environments;
 - bed and breakfast type environments;
 - areas for communal use in blocks of flats or in launderettes.

GENERAL SAFETY INSTRUCTIONS (Cont.)

CLEANING AND MAINTENANCE

- Before cleaning or maintenance, always unplug the appliance from the power socket. Make sure you pull by the plug, not the cord as this can damage the power cord and cause a hazard.
- Only the filter requires regular cleaning, everything else is non user-serviceable parts. Do not try to repair, disassemble or modify the appliance.
- Check and clean the lint filter on a regular basis
- **Service:** Never try to repair, modify or replace any part of the appliance, unless this manual says you can do so. All other servicing is to be done by a qualified technician, or contact our support centre on info@ayonz.com for advice.

PRODUCT OVERVIEW

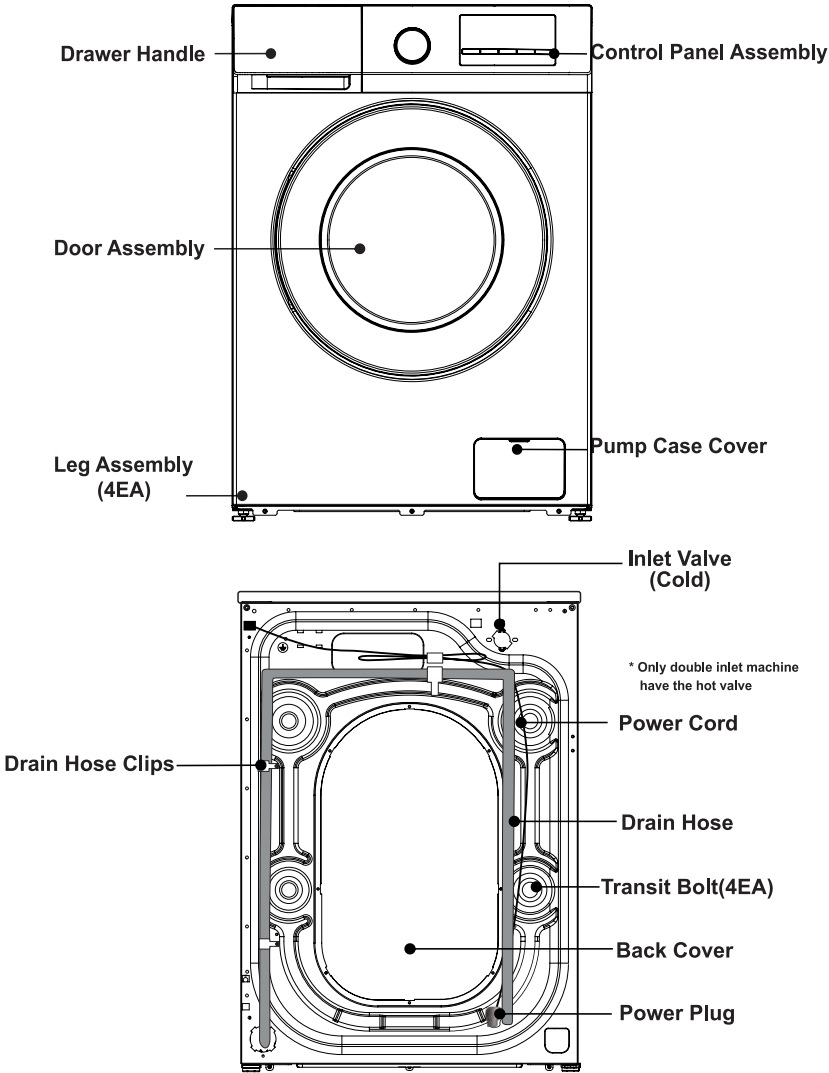

INSTALLATION INSTRUCTIONS

NOTE: We recommend that your new washer be installed by a qualified appliance technician. If you feel confident in your ability to install the washer, please read the installation instructions carefully before proceeding.

TOOLS NEEDED





You may need the following tools to help with the installation of your washer:

- Scissors
- Gloves
- Pliers
- Spanner
- Standard Screwdriver

UNPACKING THE WASHING MACHINE

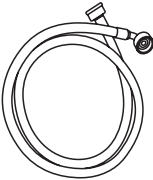
Unpack your washing machine and check for any damage that may have occurred during transportation. Also, ensure that all the items (as shown below) in the attached bag are included. If there is any damage to the washing machine or any missing/damaged items, please contact your local dealer immediately.

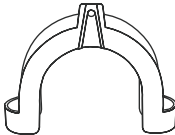
Note: If the washing machine does not have a double inlet, it does not include a hot water inlet hose.

INLET HOSE (Connects to cold water supply)	4 x HOLE COVERS (Used to plug transit bolt holes)	DRAIN HOSE SUPPORT BRACKET (Used to secure the end of the drain hose)	SPANNER 1. Used to adjust the bottom of the machine 2. Used to remove the transport bolts on the back of the machine
			

SELECT THE LOCATION

Before installing the washer, ensure the location meets the following requirements:

- A rigid, dry, and level surface (if not level, adjust using the “Adjustable Leg” as shown in the following figure).
- Avoid direct sunlight.
- Ensure adequate ventilation.
- The ambient temperature should be between 0-40°C.

INSTALLATION INSTRUCTIONS (CONT.)

- The ambient humidity should be below 95% (at a temperature of 25°C).
- Keep the washer away from heat sources such as coal or gas.
- Ensure the washer is not placed on top of the power cord.
- Do not install the washer on a carpeted floor.

REMOVE TRANSIT BOLTS

Before using the washing machine, the transit bolts on the back of the unit must be removed. Please follow the steps below:

Note: Keep the transit bolts for future use.

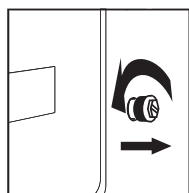

1. Loosen the four transit bolts using a spanner.

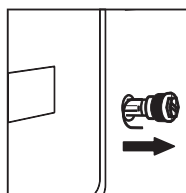

2. Pull each bolt head through the wide part of the hole and remove it. Repeat for each bolt.

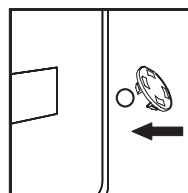

3. Insert the supplied plastic covers into the holes.

LEVEL THE WASHING MACHINE

Install the washing machine in an environment where the temperature is above 0°C and not outdoors, as cold temperatures may damage the control system.

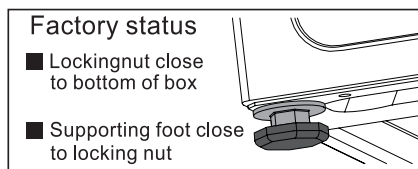
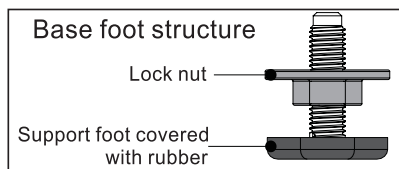

Note: To facilitate installation, the factory status of the feet may not be locked. Ensure all four feet are properly locked before leveling.

INSTALLATION INSTRUCTIONS (CONT.)

LEVELING PROCEDURE:

1. Check the foot status: When placing the machine, check if the foot is in the factory position. If not, restore it by ensuring the locking nut is tightly fixed to the bottom of the box and the support foot is locked tightly against the nut.

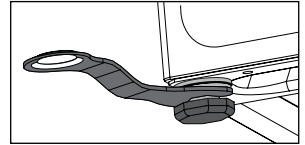

2. Check for vibration: After placing the machine, press the opposite corners of the top plate with both hands and shake vertically to ensure the support feet are in contact with the ground and the machine is stable.

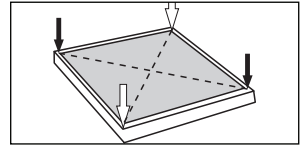

3. Adjust the support feet: Loosen the locking nut using the spanner and adjust the height until all support feet touch the ground and the machine does not shake. Then, tighten the locking nut to fix the position.

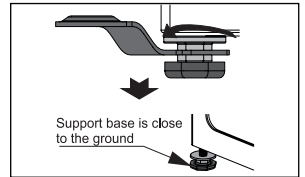

4. Secure the adjustment: Finally, use the spanner to turn the locking nut back up to secure it to the bottom of the box. You may also hold the support foot by hand to prevent it from moving while tightening.

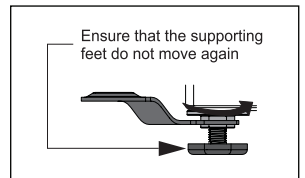

CAUTION

- 1. Leveling:** The machine must be perfectly level and stable with all support feet firmly on the ground. Lower the feet as much as possible to ensure contact with the floor.
- 2. Improper leveling may cause:**
 - Loud noise
 - Vibration
 - Machine movement
 - Other operational issues
- 3. Air-vent placement warning:** An air-vent is located on the machine's bottom (may vary by model). Install the washer only on solid, smooth, and non-slip flooring. Do not place it on blankets, wooden floors, or uneven surfaces such as desktops or stands, as this may block airflow.

INSTALLATION INSTRUCTIONS (CONT.)

The provided water hose may vary depending on the model.

Please follow the instructions according to the provided water hose.

CONNECT THE INLET HOSE

Connecting to a Threaded Water Tap

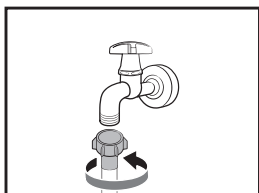

1. Connect the water hose to the tap, and turn the connector clockwise as shown.

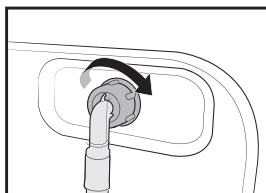

2. Connect the other end of the water hose to the inlet valve on the back of the washing machine. Turn the hose clockwise to tighten.

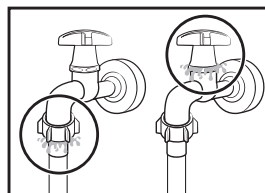

3. Open the water tap and check for any leaks around the connection points. If there are any leaks, repeat the steps above.

Connecting to a Non-Threaded Water Tap

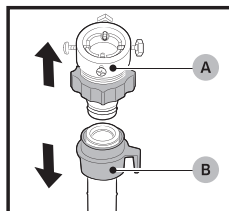

1. Remove the adaptor (A) from the water hose (B).

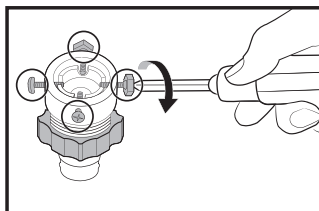

2. Use a Phillips screwdriver to loosen the four screws on the adaptor.

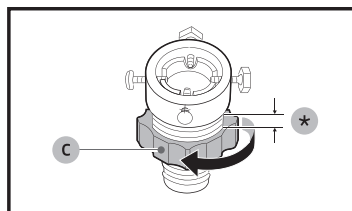

3. Hold the adaptor and turn part (C) counterclockwise to loosen it by 5 mm (*).

INSTALLATION INSTRUCTIONS (CONT.)

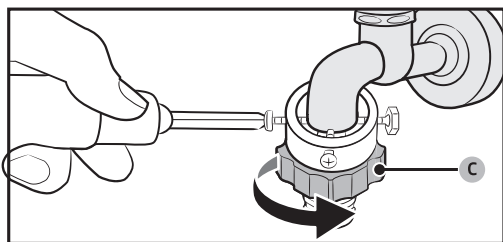

4. Insert the adaptor onto the water tap, then tighten the screws while lifting the adaptor.

5. Turn part (C) in the direction of the arrow to tighten it.

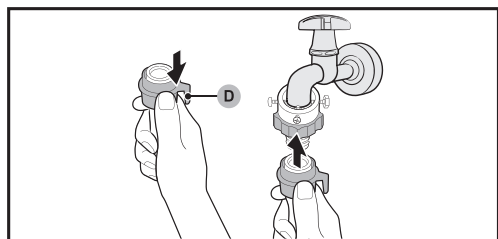

6. While pulling down part (D) on the water hose, connect the water hose to the adaptor. Then, release part (D). The hose will click into place.

7. To complete the water hose connection, follow steps 2 and 3 under “Connecting to a Threaded Water Tap”.

Note:

- If there is any leakage from the hose after connection, repeat the steps to reconnect the inlet hose.
- Do not bend the hose.
- Check the inlet hose connection carefully before using the washer each time.

CONNECT THE DRAIN HOSE

- The drain hose should be placed at a height of 65-100 cm above the floor. Failure to do so may result in poor drainage.
- You can use the supplied drain hose support bracket to loop the drain hose into a wall standpipe or laundry tub.
- Ensure all hose connections are tight.

Note: The end of the drain hose must not be immersed in water. This is necessary for the washer to function properly.

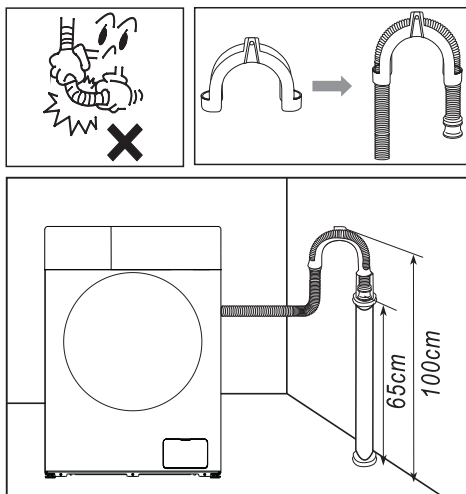

INSTALLATION INSTRUCTIONS (CONT.)

CONNECT THE POWER

- The maximum current through the unit is 10A when using the heating function. Ensure your home's power supply system (current, voltage, and wiring) meets the standard requirements for electrical appliances.
- Connect the washer to a socket that is properly installed and earthed.
- Make sure the power voltage at your socket matches the rated voltage of the machine
- The power plug must match the socket.
- Do not use a multi-purpose plug or an extension cord.
- Do not plug in or unplug the power cord with wet hands.
- When unplugging, hold the plug firmly and pull it out. Do not pull on the cord itself
- If the power cord is damaged or shows any signs of wear, use a replacement cord provided or approved by the manufacturer or service center.

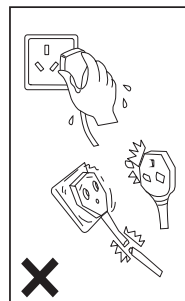

WARNING



1. This machine must be properly earthed. A short circuit or improper earthing can increase the risk of electric shock.
2. The washing machine should be operated on a dedicated circuit, separate from other appliances. Otherwise, the circuit breaker or protector may trip due to overload.

OPERATING THE WASHING MACHINE

NOTE: Ensure your machine is installed properly before use.

Before washing clothes for the first time, you must run a complete cycle without clothes.

TO DO THIS:

- Connect the power source and water.
- Put a little detergent (about 10g) into the drawer and close it.
- Press the  **On/Off** button.
- Turn the knob to the “ **Cotton**” program.
- Press the  **Start/Pause** button.

This will remove any remaining water from the manufacturer's test run inside the machine.

SORT CLOTHES

Please read the following recommendations carefully to avoid damaging the washing machine or your clothes:

1. Do not overload the machine beyond its rated capacity.
2. Sort laundry by color and care label. Most garments have a care label located at the collar or side seam.
3. Make sure all pockets are empty. Foreign objects (e.g., nails, coins, paper clips, etc.) can damage garments and machine components.
4. Close all zippers and fasten hooks, etc., before washing.
5. Sort clothes by color. Dark clothes should not be washed with light-colored ones.
6. Pre-treat heavily soiled areas or stains with liquid detergent or stain remover.
7. Turn clothes inside out if they pill easily or have a woolen surface before placing them into the machine.

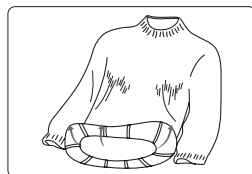
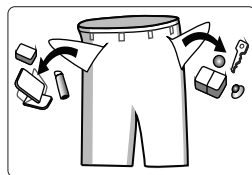

NOTE: Make sure no clothes are caught between the door and the seal.

PUT DETERGENT

- Pull out the detergent drawer.
- Add detergent for prewash into compartment I.
(Use only for prewash programs.)
Option 1: Solid detergent
Option 2: Liquid detergent
- Add detergent for the main wash into compartment II.
Option 1: Solid detergent
Option 2: Liquid detergent
- Add fabric softener into compartment 

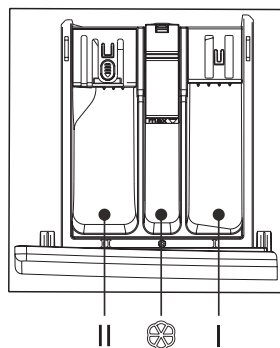

OPERATING THE WASHING MACHINE (CONT.)

- Please choose a suitable type of detergent for the desired washing temperature to achieve the best washing results with less water and energy consumption.
- Detergent/softener should be added only once per wash cycle. Please refer to the manufacturer's instructions for the correct dosage.
- Excessive detergent may create too much foam, which can overflow and make it harder to dissolve properly, resulting in rinsing difficulties.

NOTE

1. When using liquid detergent with the automatic release function for the first time, please run the "Super Quick" program to clean the drum and washing tub.
2. It is normal for a small amount of liquid detergent to flow into the lower water box when pulling out the detergent drawer. To avoid waste, do not pull the drawer frequently.
3. Refer to the manual for the correct amount of softener. Overloading softener can damage synthetic fibers.
4. Do not exceed the MAX level marked in the distributor box.
5. If using thick softener or bleach, dilute it first before pouring it into the distributor box.

OPERATING THE WASHING MACHINE (CONT.)

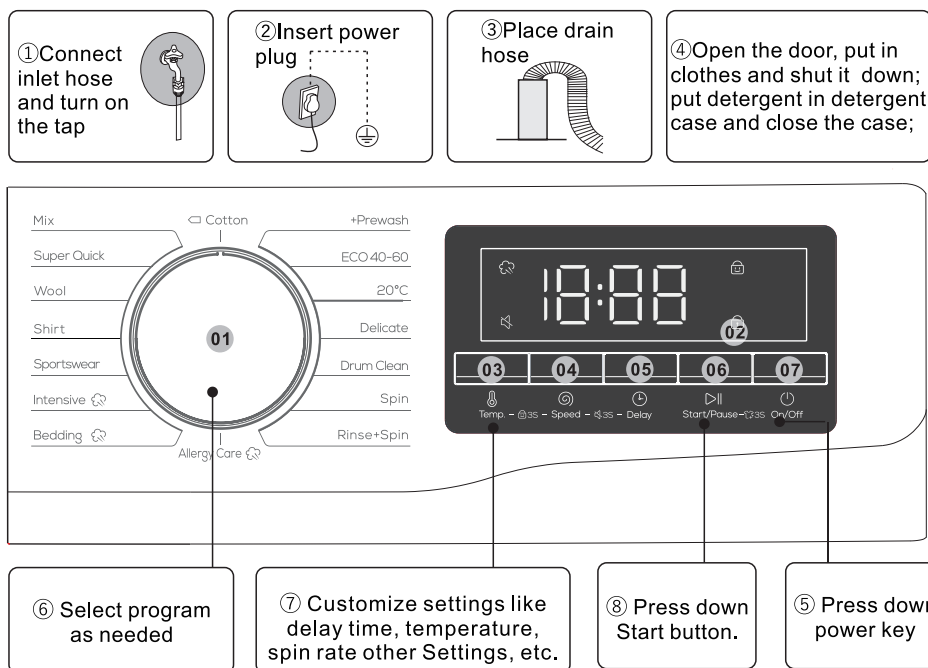

- Press the Power **On/Off** button to turn on the washing machine.
- Turn the Cycle Selector to choose a cycle.
- Adjust the cycle settings (temperature, speed, etc.) as needed.
- Set a Time Delay if you want the wash cycle to finish at a specific time.
- Press **Start/Pause**.

To change the cycle during operation:

- Press **Start/Pause** to stop the current operation.
- Select a different cycle.
- Press **Start/Pause** again to start the new cycle.

OPERATING THE WASHING MACHINE (CONT.)

CONTROL PANEL

* The following illustration is a simple example of the model control panel. This illustration is for reference only. Please refer to your actual model for precise layout and features.

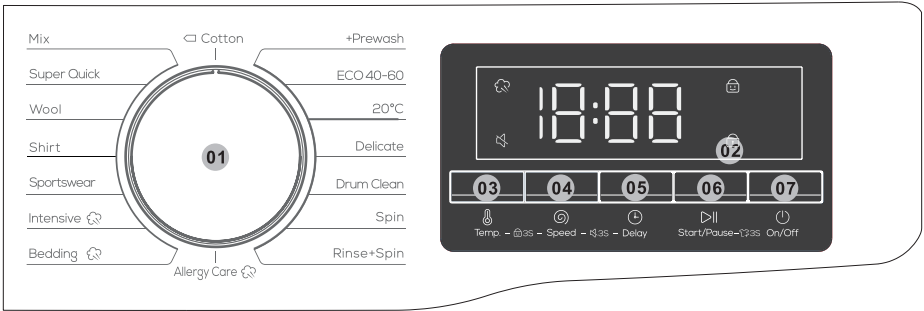



NO.	FUNCTION	DESCRIPTION
01	Cycle Selector	Turn the dial to select a wash cycle.
02	Display	Shows the current cycle information, estimated time remaining, or an error code if a problem occurs.
03	Temp.	Press to change the water temperature for the selected cycle. Available temperature settings depend on the cycle. The selected temperature will be shown on the display.
04	Speed	Press to change the spin speed for the selected cycle. Available spin speed options vary by cycle. The selected spin speed will be shown on the display.
05	Delay	Press repeatedly to cycle through the available Delay Start options (from 3 to 24 hours in one-hour increments).
06	Start/Pause	Press to start or pause operation. - Press once to start the cycle. - Press again to pause it. You may change settings during pause. - Press once more to resume the cycle.
07	On/Off	Press to turn the washing machine On or Off. If no operation is performed within 10 minutes after turning it on, the machine will shut off automatically.

OPERATING THE WASHING MACHINE (CONT.)

DELAY

You can set the washing machine to finish your wash automatically at a later time by choosing a delay between 3 and 24 hours (in 1-hour increments). The hour displayed indicates the time the wash will end.

1. Select a cycle. Then adjust the cycle settings if necessary.
2. Press  **Delay** repeatedly until the desired end time is set.
3. Press  **Start/Pause**.

The corresponding indicator will turn on and the clock will begin counting down.

4. To cancel the Delay, restart the washing machine by pressing  **On/Off**.

Real-life Case:

You want to finish a two-hour course three hours from now. To do this, add the Delay option to the selected cycle with a 3-hour setting, and press  **Start/Pause** at 2:00 p.m.

What happens? The washing machine starts operating at 3:00 p.m. and finishes at 5:00 p.m.



STEAM WASH ICON

If this icon stays lit, it indicates that the Steam Wash function is enabled.

Note: Due to different model configurations, some models may not have this feature. Please refer to your actual model for confirmation.



CHILD LOCK

To prevent accidents involving children, Child Lock disables all buttons except  **On/Off**

- To activate or deactivate Child Lock, press and hold  **Temp.** and  **Speed** simultaneously for 3 seconds.
- When activated, the  **Child Lock** indicator lights up.

ALARM OFF

You can mute or unmute the sound of the cycle selector and all buttons.

- To turn the sound on or off, press and hold  **Speed** and  **Delay** simultaneously for 3 seconds.
- When the sound is off, the  **Alarm Off** indicator lights up.

DOOR LOCK

If the door is not closed or locked properly, this icon is not lit.

Once the door is correctly locked, the icon will remain steadily lit.

RELOAD

Press and hold  **Start/Pause** for 3 seconds.

Once unlocked, the machine allows additional items to be loaded mid-cycle.

OPERATING THE WASHING MACHINE (CONT.)



PROGRAM

- **Mix:** For mixed loads consisting of cotton and synthetic fabrics.
- **Super Quick:** For lightly soiled garments (less than 2.0 kg) that need to be washed quickly.
- **Wool:** This program gently cradles and soaks wool garments to protect the fibers from shrinkage or distortion. A neutral detergent is recommended.
- **Shirt:** Use this program to wash shirts made of cotton, linen, synthetic fibers, or blended fabrics.
- **Sportswear:** Suitable for cleaning sportswear.
- **Intensive:** For heavily soiled items. The cycle time is longer than that of other programs.
- **Bedding:** Ideal for heavier items such as jeans, blankets, and bedding.
- **Allergy Care:** Features a high-temperature wash and extra rinses to effectively remove residual detergent.
- **Cotton:** For cottons, bed linens, table linens, underwear, towels, or shirts. The wash time and rinse count adjust automatically based on the load.
- **+ Prewash:** Adds a preliminary wash before the Cotton cycle begins.
- **ECO 40-60:** For cleaning normally soiled cotton items that are labeled to be washable at both 40 °C and 60 °C in the same cycle.
- **20°C:** A new European standard program designed for washing lightly soiled or delicate clothing at 20 °C. The temperature is fixed at 20 °C for energy efficiency and fabric protection.
- **Delicate:** For sheer fabrics, bras, silk lingerie, and other handwash-only garments. For best results, use liquid detergent.
- **Drum Clean:** Cleans the drum by removing dirt and bacteria. Ensure the drum is empty before use. Do not use any cleaning agents during this program.
- **Spin:** Adds an additional spin cycle to effectively remove moisture from laundry.
- **Rinse + Spin:** Adds an additional rinse followed by a spin cycle, typically after using fabric softener.

OPERATING THE WASHING MACHINE (CONT.)

TABLE OF WASHING PROCEDURES

- Washing efficiency and performance depend on the detergent used.
Use only machine-wash-approved detergent.
- If needed, use specific detergent types (e.g., for synthetic or wool fabrics).
Always follow the detergent manufacturer's recommendations.
- Do not use dry cleaning agents such as trichloroethylene or similar products.
Choose the most appropriate detergent for the wash program.

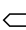
PROGRAM	10KG MAX LOAD	KIND OF DETERGENT		
		UNIVERSAL	SPECIAL	SOFTNER
Mix	6 kg	L/P	-	o
Super Quick	2 kg	L/P	-	o
Wool	2 kg	-	L/P	-
Shirt	5 kg	L/P	L	o
Sportswear	5 kg	L/P	-	o
Intensive 	6 kg	L/P	-	o
Bedding 	6 kg	L/P	L/P	o
Allergy Care 	6 kg	L/P	L/P	o
 Cotton	10 kg	L/P	-	o
+ Prewash	10 kg	L/P	-	o
ECO 40-60	10 kg	L/P	-	o
20°C	6 kg	L/P	-	o
Delicate	6 kg	L/P	L/P	-
Drum Clean	0 kg	-	-	-
Spin	10 kg	-	-	-
Rinse + Spin	10 kg	-	-	o

NOTE

- If using liquid detergent, it is not recommended to activate the delay function
- Recommended usage:
 - **Laundry powder:** 20°C to 95°C
 - **Wool detergent:** 20°C to 40°C
- Choose 95°C only for special hygienic requirements.

Legend:

- L = Liquid detergent
- P = Powder detergent
- o = Optional
- = Not applicable / Not needed

Steam Assistant  - Uses steam to enhance the washing process, offering better cleaning, fabric care, and hygiene.

OPERATING THE WASHING MACHINE (CONT.)

INTRODUCTION OF OTHER FUNCTIONS

Unlock of Emergency Door

- If you need to remove clothes during a long power outage, ensure the water level in the drum is below the safe level, the temperature is below 40°C, and the inner drum is not rotating. Then detach the drain hose and lower it to drain the water. Afterward, replace the hose.
- Open the drain pump cover located at the bottom right of the front panel. Pull the rod lightly. When you hear a click, open the door to remove or add clothes.
- Replace the drain pump cover.
- This method should only be used in emergencies.

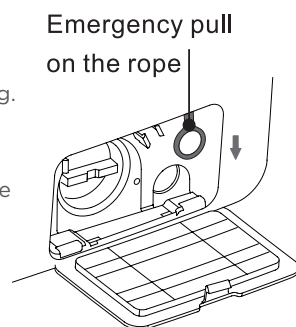

Resume Function

- This machine has a resume function in case of a power outage. If there is a power failure or the plug becomes loose during operation, the machine will remember its status and resume operation once power is restored.

Memory Function

- This function stores the most recent wash cycle automatically. When you turn the machine on again, it will recall the previous cycle and settings you used.
- The latest washing program will be selected by default when the machine starts.

Cloth Weigh Awareness

- At the start of a wash, the machine will estimate the weight of the laundry and automatically dispense the appropriate amount of detergent (if detergent is available in the case).
- Then, it adjusts the water volume to save resources effectively.

OPERATING THE WASHING MACHINE (CONT.)

Unbalance Protection

- When the machine is ready to spin, it may take a few moments to balance the clothes due to uneven distribution.
- If the clothes are still unbalanced after that, the spinning speed will be reduced to prevent excessive vibration.
- If there are too few clothes in the drum, the machine may not spin due to unbalance protection. In that case, please add more clothes to allow the machine to spin properly.

Cloth Weigh Awareness

- At the start of a wash, the machine will estimate the weight of the laundry and automatically dispense the appropriate amount of detergent (if detergent is available in the case).
- Then, it adjusts the water volume to save resources effectively.

NOTE

Due to product upgrades, some functions may differ from what is described above. Please refer to your actual model for accurate feature details.

MAINTENANCE

WARNING: Before starting any maintenance, please unplug the power cord or disconnect the power supply and turn off the water tap.

CLEAN INTERNAL DRUM

Rust left inside the drum from metal items should be removed immediately using chlorine-free detergents.

Do not use steel wool.

CLEAN SURFACE

1. If there is any water overflow, wipe it off immediately using a dry cloth. Avoid using sharp objects on the washer, as they may cause damage.
2. The surface can be cleaned with diluted, non-abrasive neutral detergents when necessary.

CLEAN THE DRAIN PUMP

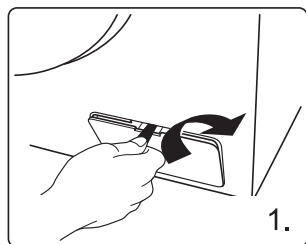

1. Open the filter cover using a tool such as a coin, following the direction shown in the graphic.

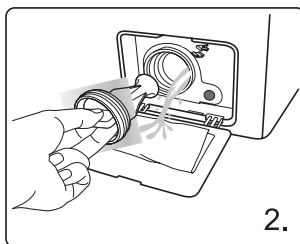

2. Unscrew the filter and be cautious of any remaining water. Remove any foreign material from the drain pump filter.

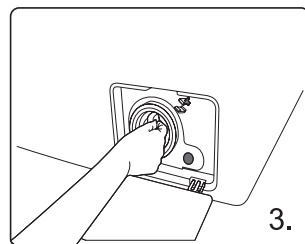

3. Reinstall the filter securely.

CLEAN THE INLET VALVE FILTER

The inlet filter should be cleaned if no water or insufficient water flows when the tap is opened.

1. Lower the water pressure:
 - a. Close the tap.
 - b. Select any program except the "Spin" cycle.
 - c. Press the Start/Pause button and let the program run for about 40 seconds.
 - d. Unplug the power cord.

MAINTENANCE (CONT.)

2. Disconnect the inlet hose from the tap.
3. Rinse the filter with clean water.
4. Reconnect the inlet hose.

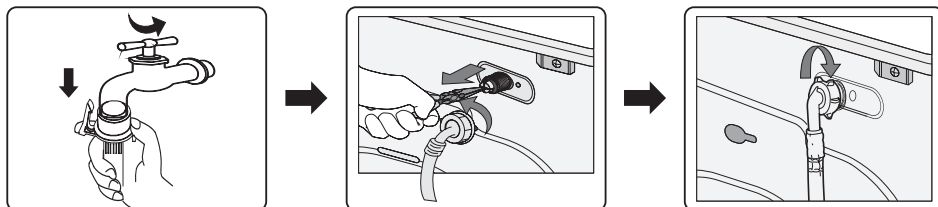

CLEAN DETERGENT DRAWER

The structure of the detergent drawer may vary depending on the machine model.

Please follow the steps and methods shown in the figure below to clean the detergent case:

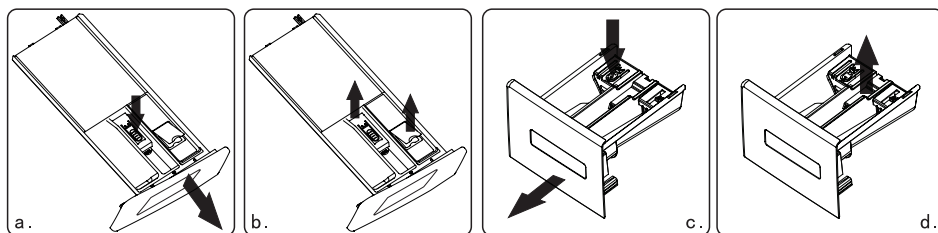

Auto Dispenser (a, b)

Common Dispenser (c, d)

- If there is detergent or softener residue in the case:
 - As shown in fig. a (or c), pull out the case and press down the limit rod to fully remove the drawer.
 - As shown in fig. b (or d), open the case (lift it up slowly) and remove the siphon plate
 - Use tap water or a brush to clean the detergent case and siphon pipe.
 - Reattach the case cover and siphon pipe, then push the drawer back in.
- A small amount of detergent may flow into the water box when the drawer is opened. This is normal.

Important Notes:

- Avoid opening and closing the detergent case repeatedly to prevent detergent loss
- Be cautious of detergent spillage, especially when adjusting or moving the machine. Remove the case before tilting or relocating the unit.

MAINTENANCE (CONT.)

RECOVERY FROM FREEZING

If the washing machine is exposed to temperatures below 0°C, it may freeze.

Steps to recover:

1. Turn off the washing machine and unplug the power cord.
2. Pour warm water over the water tap to loosen the water hose.
3. Disconnect the water hose and soak it in warm water.
4. Pour warm water into the drum and leave it for about 10 minutes.
5. Reconnect the water hose to the water tap.

NOTE

1. When reusing the washing machine, ensure the ambient temperature is above 0°C.
2. If your washing machine is located in a room where it may freeze, drain the water inside the drain hose and inlet hose thoroughly before storing or moving it.
3. Contact a technician if your washer becomes frozen.

TROUBLESHOOTING

TROUBLES	SOLUTIONS
There is some remaining water in the machine	This is normal and is the result of water tests performed at the factory.
The washer does not run	<ul style="list-style-type: none"> • Check if the power plug is properly inserted. • Check if the water tap is open. • Check if the Power button is pressed. • Check if the Start/Pause button is pressed. • Check if the delay feature is activated.
Water leakage	<ul style="list-style-type: none"> • Check and tighten the inlet hose. • Clean the drain hose and consult a service technician if needed.
Abnormal noise and excessive vibration	<ul style="list-style-type: none"> • Check if the transit bolts have been removed. • Check if the adjustable legs are properly leveled. • Ensure the washer is placed on a solid, level surface • Check for metal objects or barrettes inside the drum.
Washing efficiency is not satisfactory	<ul style="list-style-type: none"> • Select an appropriate washing program. • Use the correct amount of detergent as per the detergent package instructions.
The machine does not respond after pressing buttons	<ul style="list-style-type: none"> • Check if the Child Lock feature is activated. • Press the Start/Pause button first, then press other buttons.
The actual run time of a cycle does not match the displayed time	<ul style="list-style-type: none"> • Check if the clothes inside the drum are evenly distributed. • Check if the water is draining or filling properly.
The washer fills with water while draining	<ul style="list-style-type: none"> • Check if the height of the drain hose is less than 65 cm. • Check if the drain hose is submerged in water.

TROUBLESHOOTING (CONT.)

DISPLAY	MEANING	SOLUTION
E1	The washer fills over time	<ul style="list-style-type: none">• Check if the tap is open.• Check if the water pressure is too low.• Check if the inlet hose is blocked.
E2	Water drainage takes too long	<ul style="list-style-type: none">• Check if the drain pump is blocked.• Contact a technician if necessary.
E3	Door lock malfunction	<ul style="list-style-type: none">• Reclose the door properly.• Check if clothes are caught between the door and the seal.• Contact a technician if necessary.
E4	Water overflow	<ul style="list-style-type: none">• Ensure the water level is suitable for the selected wash program.• Contact a technician if necessary.
E5	Electrical motor malfunction	Please contact a technician.
E6	Heater malfunction	Please contact a technician.
E7	Temperature sensor fault	Please contact a technician.
E8	Mismatched software/hardware on mainboard or frequency inverter	Please contact a technician.
E9	Communication failure	Please contact a technician.
E10	Inverter failure	Please contact a technician.
EP	Selected cycle does not match the knob position	Turn the cycle selector to match the correct wash program.

NOTE Please refer to the model you purchased for the accurate fault display. Different models may show different error codes.

FABRIC CARE LABEL

	Resistant material		Can be ironed at 100°C max
	Delicate fabric		Do not iron
	Item may be washed at 90°C		Can be dry cleaned using any solvent
	Item may be washed at 60°C		Dry clean with perchloroethylene, lighter fuel, pure alcohol, or R113 only
	Item may be washed at 40°C		Dry clean with aviation fuel, pure alcohol, or R113 only
	Item may be washed at 30°C		Do not dry clean
	Item may be hand washed		Dry flat
	Dry clean only		Can be hung to dry
	Can be bleached in cold water		Dry on clothes hanger
	Do not bleach		Tumble dry, normal heat
	Can be ironed at 200°C max		Tumble dry, reduced heat
	Can be ironed at 150°C max		Do not tumble dry

SPECIFICATIONS

Power Supply	220-240V-50Hz
Water Pressure	0.05-0.8Mpa
Washing Capacity	10KG
Rated Power	1950W
Dimensions	595 (w) x 650 (d) x 850 (h) mm
Weight	Net: 70 kg / Gross: 74 kg

ELECTRICAL WARNING

To avoid fire, electrical shock, and other accidents, please carefully follow these safety reminders:

- Only use the voltage specified on the power label. If you are unsure of your home voltage, contact your local power bureau.
- When using the heating function, the maximum current can reach 10A. Ensure your power supply (current, voltage, and cable) meets the required load for the washing machine.
- Protect the power cord properly. The cord must be securely fixed to prevent tripping hazards or damage. Pay special attention to the plug location.
- Do not overload wall sockets or use extended cables. Overloading may cause fire or electrical shock. Do not unplug the power cord with wet hands.
- For safety, always plug the washer into a grounded socket.
- Ensure your socket is properly earthed and secure.

TELEFUNKEN

CUSTOMER HELPLINE:

info@ayonz.com

02 8279 8606

DISTRIBUTED BY:

Ayonz Pty Ltd