

# FERGUSON

# 50"

## Tizen OS

Developed by Samsung

QLED

4K ULTRA HD TV



Please read this manual carefully before using, and keep it for future reference.



# CONTENTS

---

General Safety	4
Technical schedule	16
Specification	17
Installation	19
Controls and Connections	21
Remote Control	23
Initial setup	26
Home Dashboard	31
Privacy Choices	32
Search	32
Gaming Hub	33
Media	34
Source(Input)	35
Settings	36
Apps	37
Picture	38
Sound	39
Connection	40
Broadcasting	41
General & Privacy	42
Support	43
FAQs	44

---

# GENERAL SAFETY INSTRUCTIONS

**Read this instruction manual carefully as it contains important information on the safety, use and maintenance of the appliance. Keep the manual for future reference.**

1. Disconnect the plug from the wall socket in case of a long period of disuse. Disconnect the plug and antenna cable even in severe thunderstorms.
2. Do not pull the cable to pull the plug out of the socket
3. Do not rest heavy objects on the cables
4. Do not bend or knot the cables
5. The TV screen is made of a fragile material, therefore, it should not be subjected to impact or pressure to avoid damage. If it is damaged, remove the plug from the socket and contact a service center. If liquid comes out of the panel, be careful and do not let it come into contact with your eyes and mouth, contact a doctor if necessary.
6. Switch off and unplug from the mains before cleaning and maintenance. For cleaning, use only a clean dry cloth. Do not use aggressive detergents such as thinners, alcohol, petrol.
7. Place the device on a stable surface that can withstand its weight. If you are using a mobile, it must be strong and large enough to prevent the TV from protruding beyond edges of the cabinet. If it is fixed to the wall, follow the instructions for correct fixing to avoid danger. Do not place the TV in high positions (furniture, shelves, shelves) unless they are properly fixed to the wall. Do not place any textile or similar product between the TV and the furniture. It is necessary to inform children about the dangers so as to prevent them from climbing on the furniture to reach the TV and its accessories.
8. Leave adequate space on the sides of the TV to ensure proper ventilation
9. Do not expose the TV to direct sunlight, heat sources or naked flame sources (candles)

## GENERAL SAFETY INSTRUCTIONS (Cont.)

10. No objects containing liquids, such as vases, should be placed on the TV. Avoid exposure to drops and splashes of water.
11. Connect only to a mains socket that complies with the regulations in force and in accordance with the rating plate data of the TV. The mains socket must be close and easily accessible to disconnect the TV in case of danger. If the TV does not have a specific shutdown switch, to turn off the TV, disconnect the mains plug.
12. Do not insert objects of any kind into the slots of the TV due to the danger of electric shock. If the TV does not have a specific shutdown switch, to turn off the TV, disconnect the mains plug.
13. Do not insert objects of any kind into the slots of the TV due to the danger of electric shock.
14. Read this manual carefully before using the TV.
15. Keep this manual, the complete warranty card, receipt, and product packaging. The safety precautions instructions reduce the risk of fire, electric shock and injury when followed correctly. Please follow all instructions and take note of all warnings.

# GENERAL SAFETY INSTRUCTIONS (Cont.)

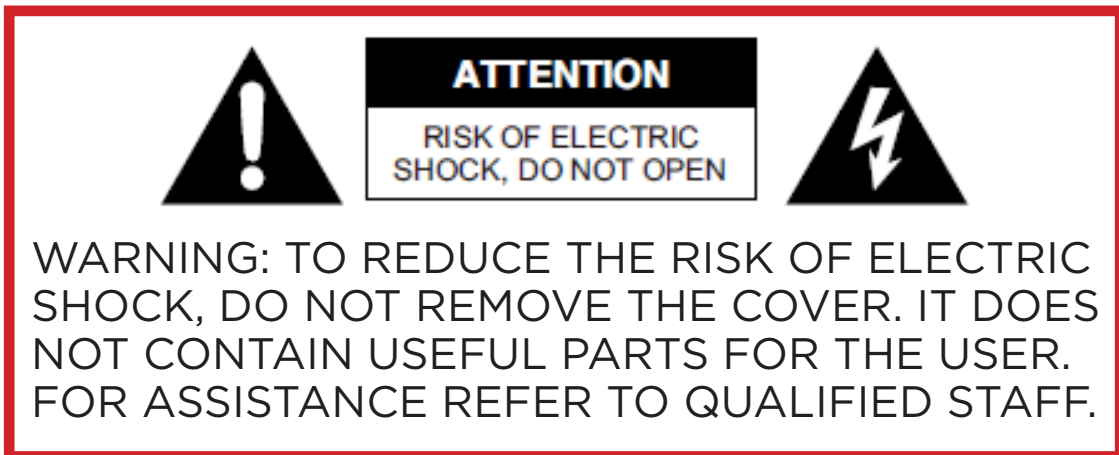

**ATTENTION**  
RISK OF ELECTRIC SHOCK, DO NOT OPEN

WARNING: TO REDUCE THE RISK OF ELECTRIC SHOCK, DO NOT REMOVE THE COVER. IT DOES NOT CONTAIN USEFUL PARTS FOR THE USER. FOR ASSISTANCE REFER TO QUALIFIED STAFF.

The cover (or back) of the unit should not be removed to prevent risk of electric shock.

This unit must be serviced by a qualified service personnel only.



The lightning flash with symbol within the triangle is intended to warn you of a non-insulated dangerous voltage in the product's enclosure that could be of sufficient magnitude to generate a risk of electric shock to persons.



The exclamation point within the triangle is intended to warn you to the presence of important operating and maintenance instructions in the documents included with the product.



To avoid possible hearing damage, limit the listening time to high volumes.

## GENERAL SAFETY INSTRUCTIONS (Cont.)

### **WARNING**

1. Use furniture or stands recommended by the manufacturer.
2. The product must be installed on a surface that correctly supports its weight.
3. Make sure that the product rests completely on the surface on which it is installed.
4. Do not place the product on a tall cabinet without fixing neither the cabinet nor the product stably.
5. This will prevent the TV from falling.
6. Do not place the product on top of conductive or flammable fabrics or other materials.
7. Make sure that children do not climb onto the furniture or support where the TV is installed, with the intention of getting close to it, thus avoiding any risk of falling of the support or product;  
any operation on the TV must be carried out by an adult.

### **WARNING**

1. Do not expose this appliance to rain or moisture as it may cause a fire or an electric shock hazard.
2. Do not tamper with or modify the product in any way.
3. Use only accessories described and recommended by the manufacturer.
4. Please do not expose the product to direct contact with water.
5. Do not place any objects on top of the product, including liquid containers such as glasses.
6. Be careful when replacing the remote controller battery; incorrect installation can lead to explosion risks. Replace with the same or equivalent type of battery.

# GENERAL SAFETY INSTRUCTIONS (Cont.)

## **Installation**

16. To install the TV, please follow the instructions in this manual. This product must be placed on a sufficiently stable surface; incorrect installation is potentially dangerous as the TV could fall and cause injury. Be extremely careful around children.
17. Before installing the product, make sure that the output voltage corresponds to that indicated on the rear label of the TV where the electrical specifications are shown.
18. Do not use a damaged power cord or plug, or a power outlet with a loose connection. This could cause an electric shock.
19. Do not connect multiple devices to the same socket. This could cause the outlet to overheat and cause a fire. Make sure that the socket is easily accessible when operating the TV.
20. Do not bend, wrap or twist the power cord excessively.
21. Do not let anything rest on the power cord and antenna cable. This could cause a fire or electric shock.
22. Do not use the power cord near appliances that produce heat such as radiators, stoves, or irons. Excessive heat could melt the insulation and expose live wires, causing fire or electric shock.
23. Unplug this TV during lightning storms or when unused for long periods of time. Otherwise, it could result in fire or electric shock.
24. Do not block the ventilation openings of the product with items such as newspapers, tablecloths, curtains. Do not insert objects into the slots available on the sides and rear of the TV. This could cause the temperature inside the TV to rise and cause a fire.
25. If you notice any unusual smells or smoke coming from the TV, unplug the power cord from the outlet immediately and contact the service center. Otherwise, it could result in fire or electric shock.
26. When not using the TV for long periods of time or when it needs to be moved, be sure to disconnect the power cord from the wall outlet.

## GENERAL SAFETY INSTRUCTIONS (Cont.)

27. The TV should be cleaned periodically. Otherwise, the dust could accumulate over time and cause the temperature inside the TV to increase and / or the insulation of the connections to deteriorate, which in turn could cause an electrical fire.
28. The product is not intended for use by people (including children) with reduced physical, sensory or mental abilities, or small children of any age, unless supervised by an adult responsible for their safety.
29. The remote controller batteries should only be removed by an adult, making sure to keep them out of the reach of infants and children. Seek immediate medical attention if a child has swallowed a battery.
30. Batteries should not be exposed to direct sunlight or heat.
31. To clean the TV, do not use chemicals, detergents, or wet cloths, be sure to use a dry cloth to clean it of marks or dust and only after unplugging the product from the power outlet.
32. Contact a qualified service center for any repair or other service required.

# GENERAL SAFETY INSTRUCTIONS (Cont.)

## **WARNING!**

1. We strongly recommend that you lock the TV to the stand on which it is installed.
2. In this way, accidents caused by the furniture or TV overturning can be prevented.
3. To avoid any risk of serious injury, we strongly recommend that this product be permanently attached to the wall or another suitable surface.
4. Fasteners are not included as surfaces made of different materials require different fixtures. Please contact qualified personnel.
5. If a TV is not placed stably enough, it can be potentially dangerous due to accidental fall. Many injuries, particularly for children, can be avoided by taking simple precautions such as:
  6. Use furniture or stands recommended by the manufacturer.
  7. The product must be installed on a stand that can support the weight and size of the TV.
  8. Make sure that the product rests completely on the surface on which it is installed.
  9. Teaching children about the dangers that can arise from climbing on furniture with the aim of reaching

### **Be sure to position the product according to the following considerations:**

33. Prefer dry surfaces in well ventilated areas.
34. Do not expose to sunlight and other heat sources.
35. Do not expose to contact with water or other liquids.
36. Protect from dust and pollutants.
37. Do not install the TV on furniture with limited space, such as bookcases.
38. Do not install the TV near heat sources such as radiators, stoves or other appliances that produce heat.

## GENERAL SAFETY INSTRUCTIONS (Cont.)

39. Do not place containers with liquids next to the TV; if the liquid were to fall and penetrate inside the casing, it could cause short circuits, fires or electric shocks.
40. Do not place small metal objects on top of the unit; if such objects penetrate the TV casing, this could cause short circuits, fire or electric shock.
41. Do not use or store flammable or combustible materials near the unit. This could cause fire or explosion. Do not place open flames, such as lighted candles, cigarettes, or incense sticks on top of the TV.
42. It is advisable that the antenna is installed away from the power outlet; Please contact a professional antenna technician to install the antenna, to avoid incorrect installation which could cause fire, electric shock, or serious injury.
43. Install the unit at a reasonable distance from the wall to ensure sufficient ventilation.
44. Connect the power supply of your TV to an easily accessible and easy to disconnect socket.
45. Do not use this apparatus near water. For example, do not use near a laundry tub, in a wet cellar, near a swimming pool or the like.
46. Clean the appliance only with dry cloths.
47. Do not block the ventilation openings. Install in accordance with the manufacturer's instructions. The slots and openings on the back or bottom are for ventilation, to ensure reliable operation of the TV and to protect it from overheating. Do not block or cover these openings. Do not block the openings by placing the TV on a bed, a sofa or similar surfaces.
48. Do not install this unit near heat sources such as radiators, heating vents, stoves or other apparatus (including amplifiers) that produce heat.

## GENERAL SAFETY INSTRUCTIONS (Cont.)

49. Do not alter the safety purpose of the polarized or grounding-type plug. A polarized plug has two blades with one wider than the other. A grounding plug has two blades and a third grounding prong. The largest lamella or the third pole perform a protective function. If the provided plug does not fit into your outlet, consult an electrician for replacement of the obsolete outlet.

50. Protect the power cord from being walked on or pinched particularly at plugs, convenience receptacles, and the point where the cord exits the apparatus.



51. Use only accessories specified by the manufacturer.

52. Use only with the cart, stand, tripod, bracket, or table specified by the manufacturer, or sold with the apparatus. When using a cart, be careful when moving the cart and the appliance together to avoid injury from overturning. The TV / cart assembly must be moved with care. Quick stops, excessive force, and uneven surfaces could cause the cart and TV to tip over.

53. Unplug this apparatus from the power supply during lightning storms or when it will not be used for a long time. For added protection of the TV receiver during a lightning storm or when it is not used for an extended period, unplug it from the wall outlet and disconnect the antenna or cables. This will prevent damage to the TV caused by lightning or power surges.

54. Have repairs carried out by qualified service personnel only. Maintenance is required if the appliance has been damaged in any way, such as damage to the power cord or plug, if liquid has been spilled or objects have fallen into the appliance, appliance has been exposed to rain or moisture, if it does not operate normally or has been dropped.

55. This TV should only be operated with the type of power source indicated on the rating plate. If you are unsure of the type of power supply in your home, consult your dealer or local power supplier. For battery power supply of the TV remote control, refer to the operating instructions.

## GENERAL SAFETY INSTRUCTIONS (Cont.)

56. The television should not be exposed to dripping or splashing water. Do not place objects filled with liquids, such as vases, on the TV.

57. Never push objects of any kind into the TV through openings as they may touch dangerous voltage points or other electrical components which could result in fire or electric shock. Do not spill liquids of any kind on the TV.

58. Unplug the TV from the wall socket before cleaning. Do not use liquid or aggressive detergents. Use a damp cloth for cleaning.

59. Do not place the television near or on top of radiators or other heat sources. Do not place the TV in recessed places such as bookcases or shelves unless adequate ventilation is provided or the manufacturer's instructions are followed.

60. Do not place the TV on an unstable cart, stand, tripod, bracket or table. The TV may fall, causing serious injury or damage to the set.

61. Do not try to repair the TV yourself. As opening or removing covers may expose the user to dangerous voltage or other hazards. Have repairs carried out by qualified service personnel only.

62. **WARNING:** To avoid injury, the appliance must be securely fastened to the floor or wall according to the installation instructions.

# GENERAL SAFETY INSTRUCTIONS (Cont.)

## TREATMENT AND DISPOSAL OF BATTERIES

1. ATTENTION: incorrect replacement of the batteries or the use of batteries of different types non-equivalent can cause explosions.
2. The battery should not be exposed to excessive heat such as that from the sun, fire or similar sources.
3. Do not mix different types of batteries, or new batteries with old ones.
4. The battery must be positioned according to the correct polarity.
5. If the battery is low it must be removed from the product.
6. The battery must be disposed of safely. To protect the environment, always use the appropriate collection containers (consult your dealer).
7. Keep batteries away from children and pets. Only adults are allowed to take care of the batteries.
8. Never throw batteries into fire or expose them to flames or other heat sources.
9. Follow the safety and use instructions for the battery.



The terms HDMI, HDMI High-Definition Multimedia Interface, and the HDMI Logo are trademarks or registered trademarks of HDMI Licensing Administrator, Inc.



# GENERAL SAFETY INSTRUCTIONS (Cont.)

## **CLEANING AND MAINTENANCE**

1. Unplug the unit from the electrical outlet before cleaning.
2. To remove dust, wipe gently with a soft, lint-free cloth.
3. If necessary, use a slightly damp cloth.
4. Clean the plug with a dry cloth at regular intervals.
5. CAUTION: Moisture and dust can lead to fire or electric shock.
6. Be careful not to use liquids or detergents that can get inside the TV. (Liquid inside the TV may cause product failure, fire or electric shock.)
7. Do not clean with abrasive cloths and aggressive products such as insect repellents, solvents, thinners or other substances that may deteriorate the surface and finish of the TV cabinet.

# TECHNICAL SCHEDULE

Information	Value and precision			Unit
Supplier's name or trade mark	FERGUSON			--
Supplier's model identifier	AF500UTQ			--
Energy efficiency class for standard Dynamic Range (SDR)	F			--
On mode power demand for Standard Dynamic Range (SDR)	62			W
Energy efficiency class (HDR)	F			--
On mode power demand in High Dynamic Range (HDR) mode	65			W
Off mode, power demand	0			W
Standby mode, power demand	≤0.5			W
Networked Standby mode, power demand	≤2			W
Electronic display category	television			--
Size ratio	16	:	9	integer
Screen resolution (pixels)	3840	x	2160	pixels
Screen diagonal	127			cm
Screen diagonal	50			inches
Visible screen area	6755			cm <sup>2</sup>
Panel technology used	LED LCD			--
Automatic Brightness Control (ABC) available	NO			--
Voice recognition sensor available	NO			--
Room presence sensor available	NO			--
Image refresh frequency rate	60			Hz
Minimum guaranteed availability of software and firmware updates (until):	8 year			--
Minimum guaranteed availability of spare parts (until):	7 year			--
Minimum guaranteed product support (until):	09/20/2026			--
Power supply type:	Internal			--

# SPECIFICATIONS

<b>Display Device</b>	50" QLED 4K ULTRA HD Smart TV
<b>Resolution</b>	3840 x 2160
<b>Display Colours</b>	1.07 Billion
<b>Contrast ratio:</b>	5000 : 1
<b>Aspect Ratio</b>	16 : 9
<b>Software of Version</b>	T-23KTSU2EUSQYUABC-1200.0
<b>Input / Output</b>	<b>Tuner:</b> DVB-T2 H.265 MAIN 10, DVB-S2 HDMI x3, USB x2, OPTICAL Out x1, RF IN x1, CI+ x1, RJ45 x1, AV IN x1
<b>Multimedia Playback Format under USB Mode</b>	<b>Movie:</b> MPEG-1, MPEG-2, MPEG-4, H263, H.264, HEVC, AV1
	<b>Music:</b> MP3, WAV, FLAC
	<b>Photo:</b> JPG, JPEG, BMP, PNG
<b>Power Source</b>	100-240V ~ 50/60Hz
<b>Power Consumption</b>	115 W
<b>Dimensions</b>	<b>With stand:</b> 1111 x 290 x 715 mm ( w x d x h)
	<b>Without stand:</b> 1111 x 66 x 647 mm ( w x d x h)
<b>Weight</b>	<b>Net:</b> 9.25 kg
	<b>Gross:</b> 13.1 kg

# SPECIFICATIONS

TABLE SPECIFICATIONS RADIO / RADIO SPECIFICATIONS

Technology Radio / Radio access technology	Antenna port used / Antenna port	Minimum RF frequency band / RF frequency band	Max Output Power / Max Output Power dBm	Duty cycle
DVB-T	External IEC 9.52 Coaxial	Receiver only 174-850 MHz	-	--
DVB-S	External F Coaxial	Receiver only 950-2150 MHz	-	--
BLE	Interna PCB antenna	2402-2480 MHz (40 Channels)	7.23	100%
WiFi 2.4G	Interna PCB antenna	802.11b/g/n 20M: 2412-2472 MHz 802.11n 40M: 2422-2462 MHz	19.81 19.91	100%
WiFi 5.8G	Interna PCB antenna	802.11a/n/ac 20M: 5725-5850 MHz 802.11n/ac 40M: 5755-5795 MHz 802.11ac 80M: 5775 MHz	13.86	100%
WiFi RLAN 5G	Interna PCB antenna	802.11a/n/ac 20M: 5180-5240 MHz 802.11n/ac 40M: 5190-5230 MHz 802.11ac 80M: 5210 MHz	19.73	100%

## Restrictions on use.

**This device is restricted to indoor use only when using the frequency band 5150 to 5350 MHz.**

**This restriction is applicable in all countries of the European Union.**

	BE	BG	CZ	DK	DE	EE	IE
	EL	ES	FR	HR	IT	CY	LV
	LT	LU	HU	MT	NL	AT	PL
	PT	RO	SI	SK	FI	SE	UK(NI)

# INSTALLATION

Install the stand as described below, or if you want to mount it to a wall, please contact a professional installer.

Please ensure the TV is not plugged into the wall socket and furthermore we recommend to get another person to assist in the following task.

## Attaching the stand

### Step 1

Place a soft cushioned material on top of a flat surface to prevent damaging the screen panel. Then place the TV screen flat on top, with the screen side facing down, as illustrated on the right.

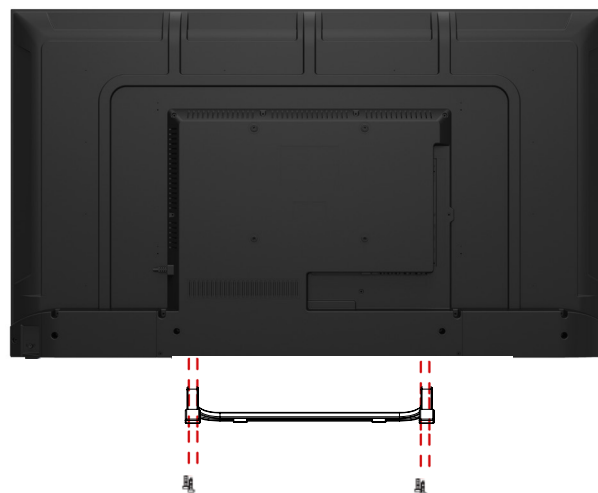

### Step 2

Align the stand leg to the installation point, as illustrated below

### Step 3

Tighten the screws (supplied) with a screwdriver to affix the stand to the panel, as illustrated on the right.

### Step 4

After installing the base, facing the TV screen, buckle the base trim into the base groove, press hard on both ends to ensure that the base trim is buckled.



## CAUTION!

Do not apply excessive force as this may damage the screw holes.

# INSTALLATION (Cont.)

## Wall-Mounting Instructions

Please ensure the TV is not plugged into the wall socket and furthermore we recommend to get another person to assist in the following task.

- We recommend you use a professional installer as we assume no liability for any eventual damage to the product or injury to yourself if you mount the TV on your own.

### BACK OF TV

VESA PATTERN: 200 x 200mm

M6\*8mm Screws (4 pcs)

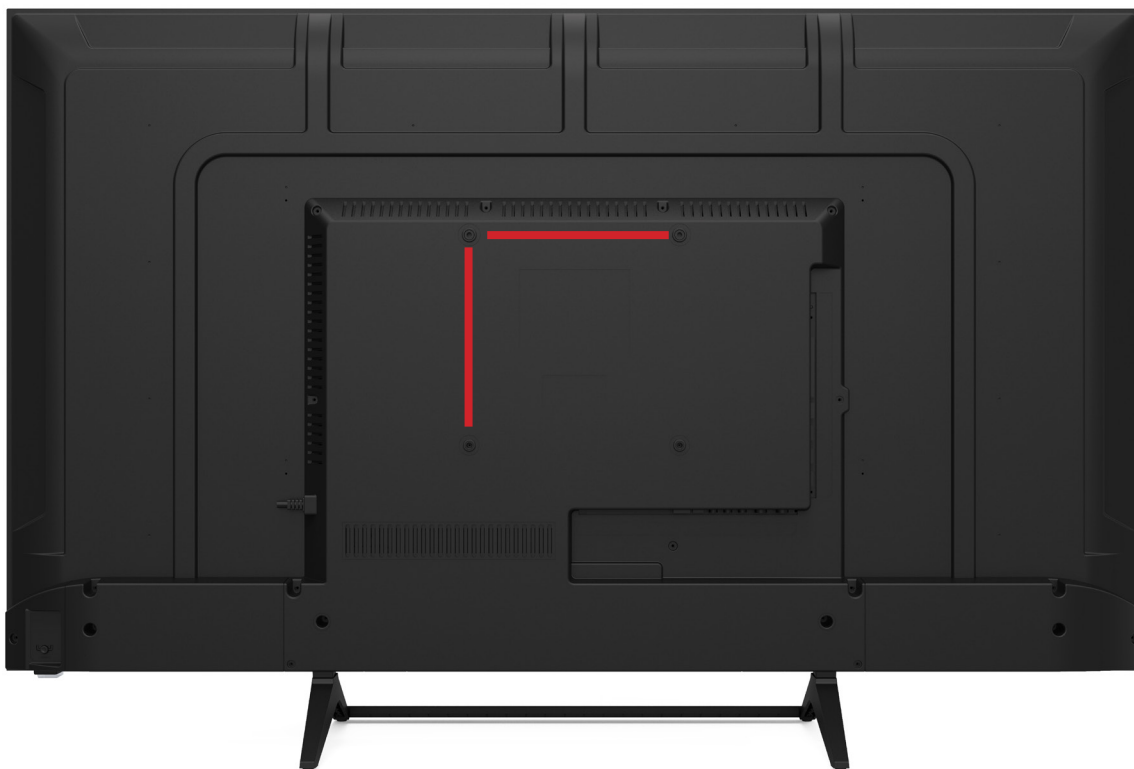

**NOTE:** If you are wall-mounting the TV, this should be done by a qualified installer.

# CONTROLS AND CONNECTIONS

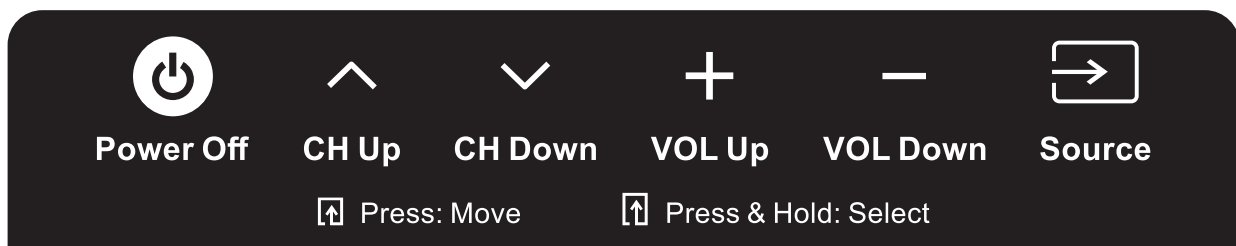
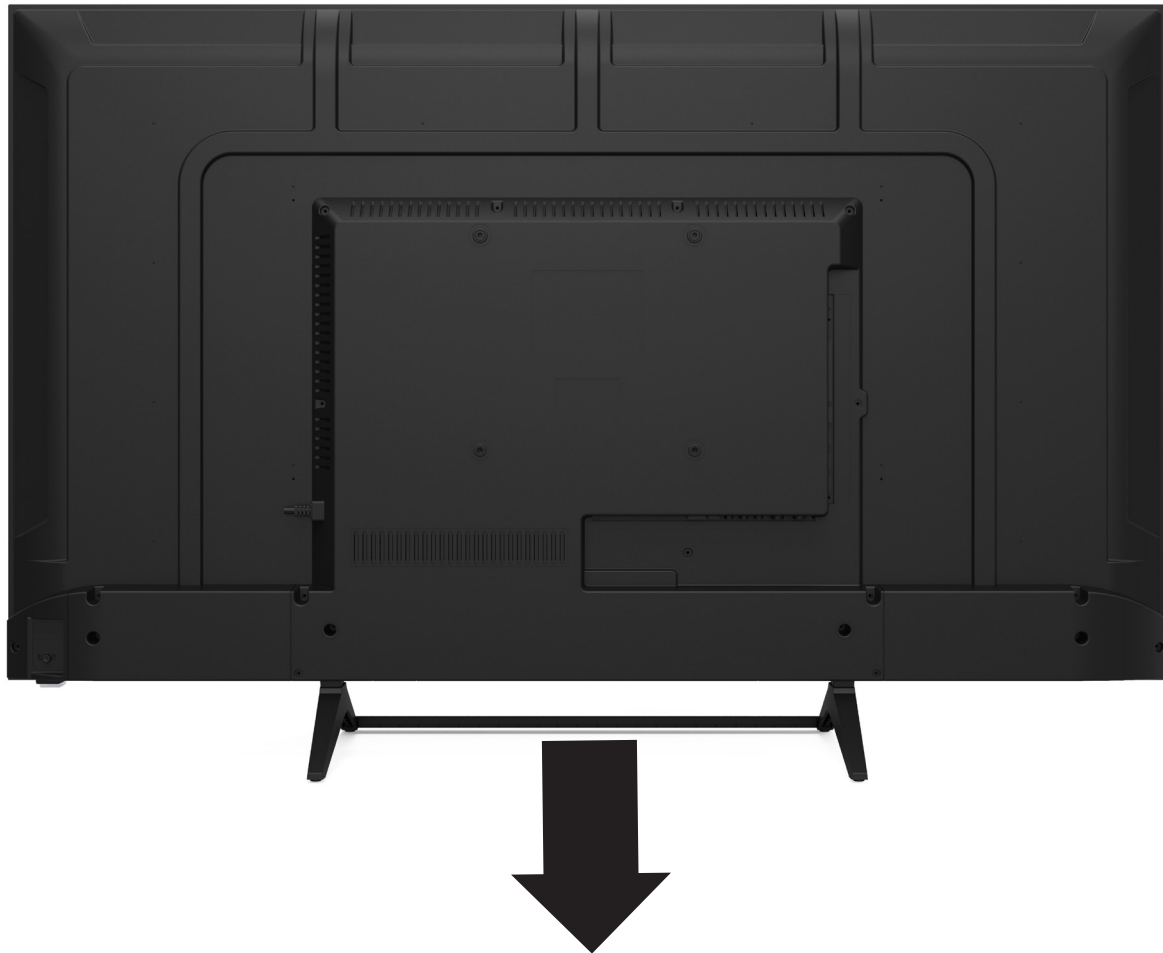

## Power:

1. When the TV is on, press this button once to open the menu bar.
2. Press the button again to move the cursor from left to right, step by step. You can adjust it as needed.
3. Press and hold the button to select the desired option.
4. Repeat 2-3 for other options.
5. Press and hold the Source to display the source list, and you can use +(VOL Up)/-(VOL Down) in the menu to select.
6. Please note: The setting menu will automatically turn off if there is no operation within a few seconds.

# CONTROLS AND CONNECTIONS

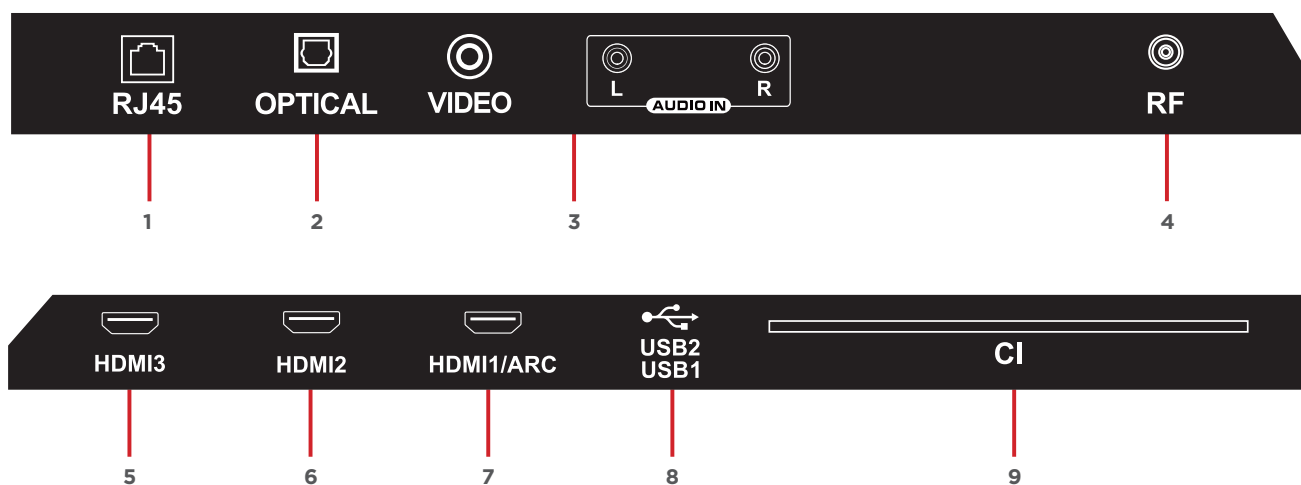









1. **RJ45**
2. **OPTICAL**
3. **AV INPUT**
4. **RF**
5. **HDMI 3**
6. **HDMI 2**
7. **HDMI 1 / ARC**
8. **USB 1 & 2**
9. **CI+**

# REMOTE CONTROL



# REMOTE CONTROL (CONT.)

1. **POWER** Turn the TV on/off.
2. **SOURCE** Select the input source mode.
3. **NUMBER BUTTONS (0-9):** Select a TV channel.
4. **TTX/MIX** non-function
5. **PRE-CH** Returns to the previous channel.
6. **MUTE** Turn the sound on or off.
7. **VOLUME** Increase or decrease TV volume.
8. **CHANNEL** Next or previous TV channel.
9. **GUIDE** non-function
10. **HOME**
11. **APPS** Open Netflix, Samsung TV Plus, PrimeVideo, Youtube.
12. **ARROWS** Navigate on-screen menu.
- SELECT** Selects or runs a focused item.
13. **RETURN** To last viewed channel.
14. **EXIT** Exits the menu.
15.  Corresponds to various colour functions in the menu.
16. **SETTINGS** Press to open the setting option.
- INFO** Display channel information.
- AD/SUBT.** Press to open the Accessibility Shortcuts.
17.  Move fast backward
-  Play
-  Pause
-  Move fast forward
-  Play previous file (Long press)
-  STOP
-  Play next file (Long press)

# REMOTE CONTROL (CONT.)

## **REMOTE CONTROL BATTERY INSTALLATION AND WARNINGS**

- Open the battery compartment cover on the back of the remote control
- Insert 2 x 1.5V type AAA batteries(not included) placing them according to the correct polarity.
- Open the battery compartment cover on the back of the remote control
- Insert the batteries (check the number of batteries and the type in the remote control compartment) with the correct polarity
- Close the battery compartment cover.
- Batteries once installed should not be exposed to excessive heat such as sunshine, fire or the like.
- Do not use old and new batteries in the remote control.
- Do not use different types of battery.
- If it is not used for a long time, it is recommended to remove the batteries from the remote control.
- Keep batteries away from children and pets.
- Never throw batteries into fire.
- Accidental dropping of the remote control, resulting in breakage, will immediately invalidate the warranty.
- The remote control works effectively when used up to about 5m away from the TV.
- Do not expose the remote controller sensor to strong light

# INITIAL SETUP

For the first initial setup, on screen setup wizard will guide you through setting up your TV. Please follow according to onscreen guide to setup your TV correctly.

Press OK button to start the setup

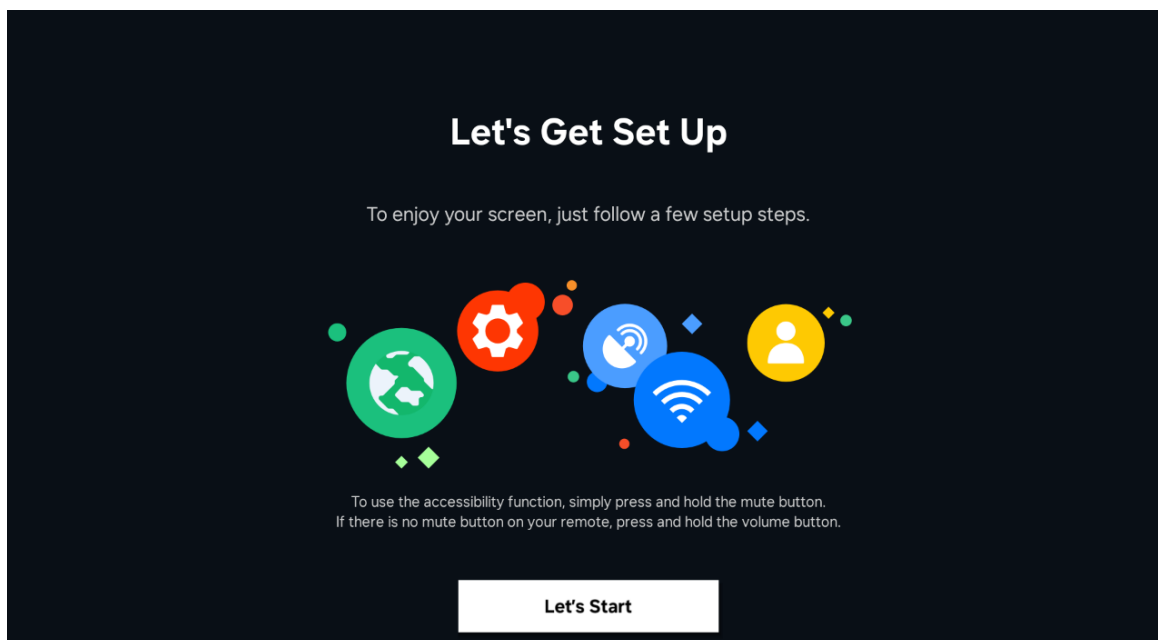

# INITIAL SETUP (Cont.)

Press to setup and choose to connect your devices to the screen to start setup.

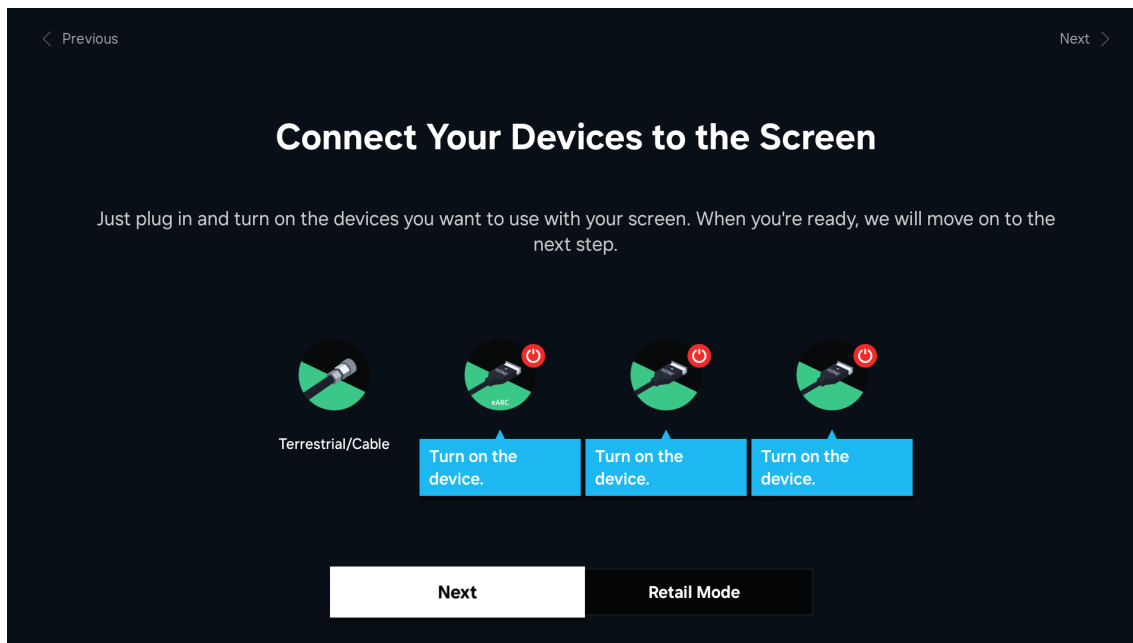

Press to select the signal setup page. Select the connected aerial that you want to use to get channels, and select each item and choose the correct setting. Then select Next to search for channels.

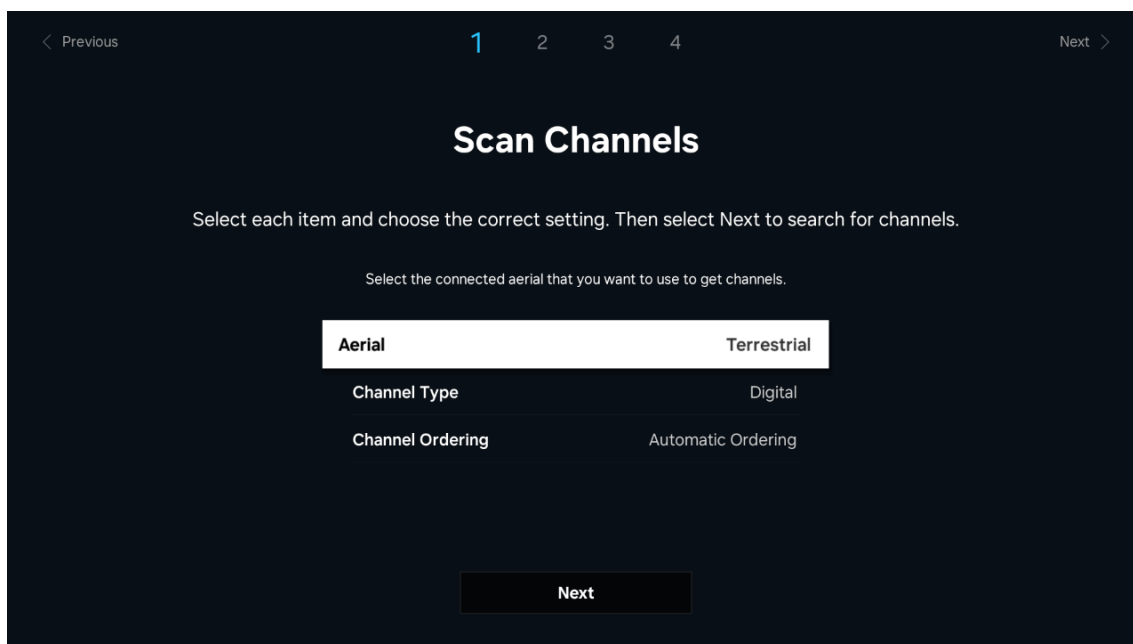

# INITIAL SETUP (Cont.)

Press to select Network and press OK button to turn to next page.

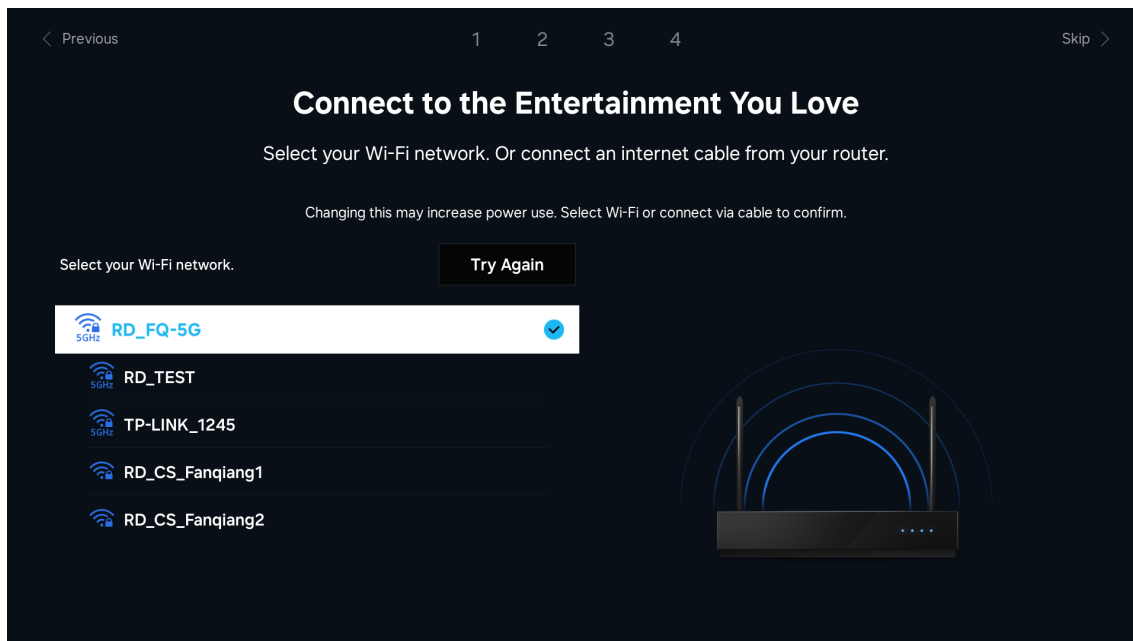

Select "OK" to agree to the Terms & Conditions and Privacy Notice, and then choose to enable specific additional service above by individually selecting.

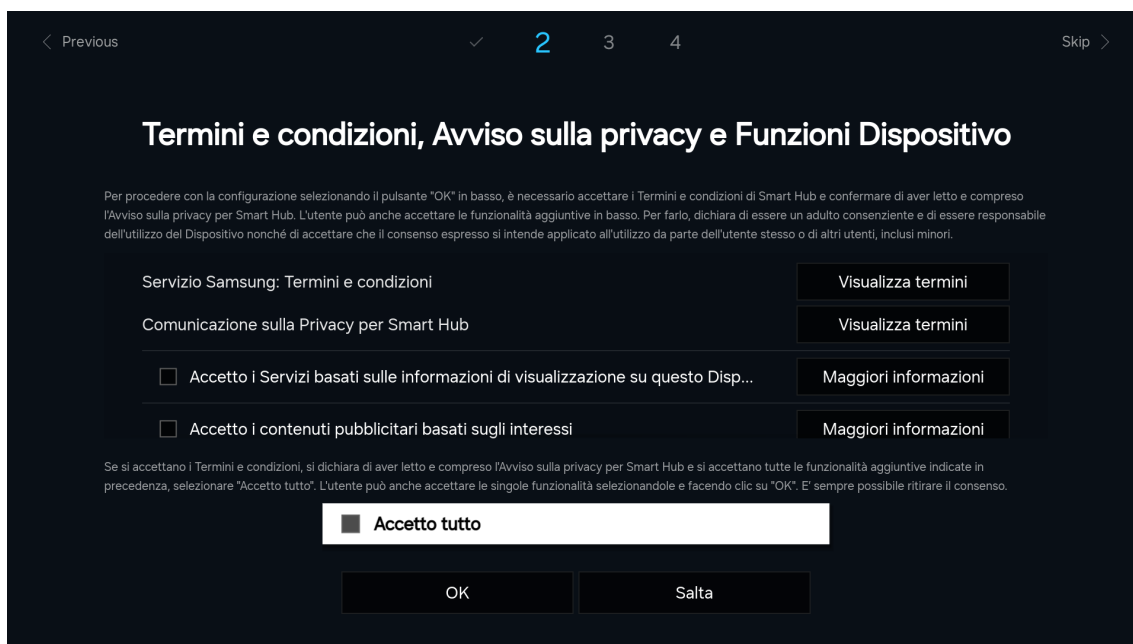

# INITIAL SETUP (Cont.)

Choose sign in the Samsung account or skip to next step.

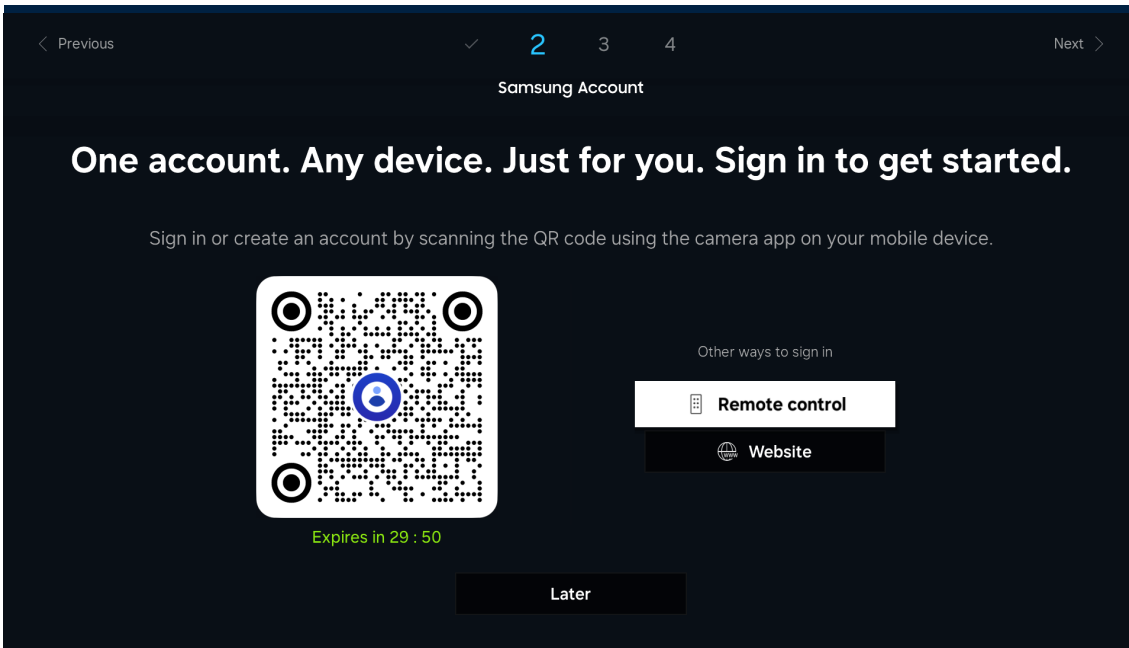

Press to select favourite services below, then simply sign up or sign in using your mobile device or PC.

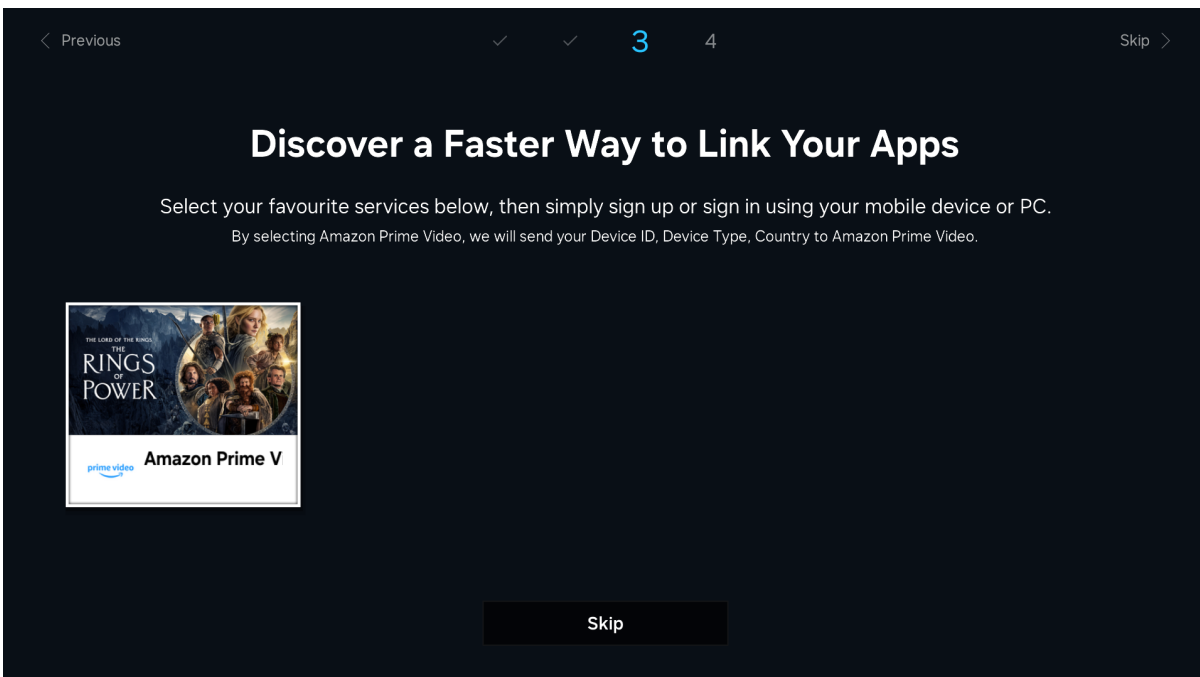

# INITIAL SETUP (Cont.)

Press to select TV source and scan channel

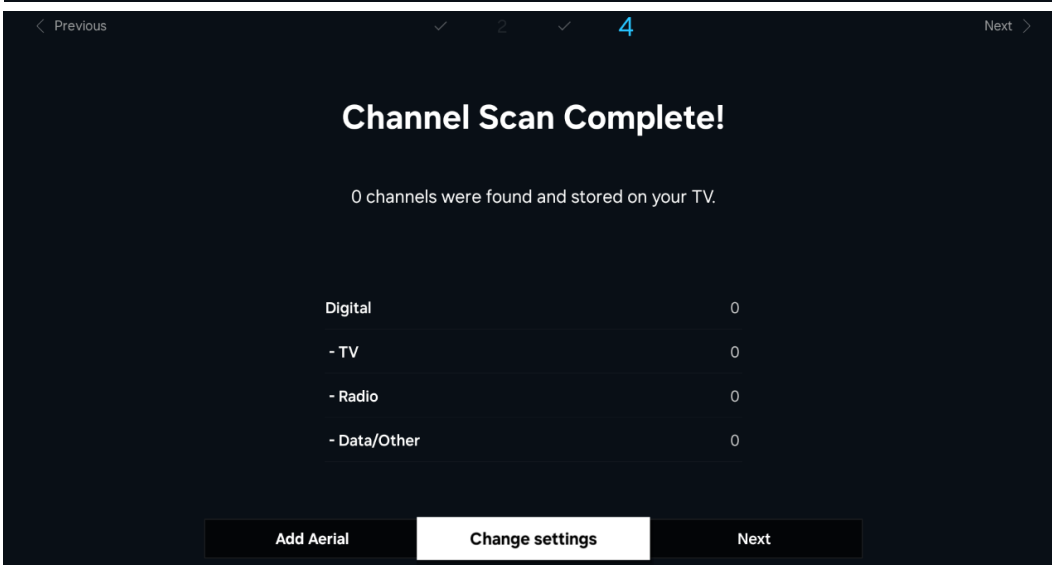
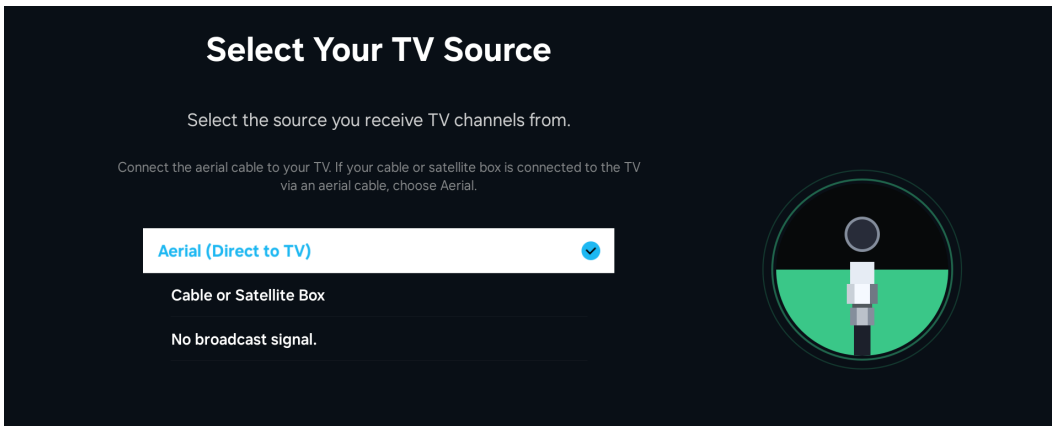

Check the settings below to make sure everything's how you want it, then enter the next step.

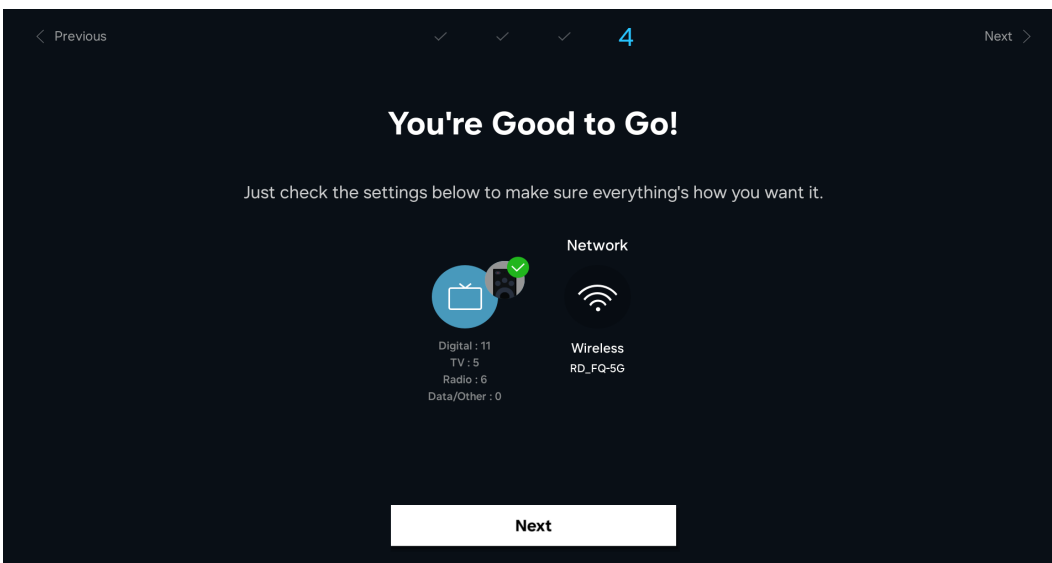

# HOME DASHBOARD

Enter the Home page after First Time install.



The home dashboard is your central hub for entertainment.

Side menus are:

1. Search
2. Gaming Hub
3. Home Dashboard
4. Downloaded Apps - App Store
5. Installed Apps - Quick Access
6. Recent watched

# PRIVACY CHOICES

Press to select Privacy Choices, then press <OK> to enter.

You can easily manage your personal information and read our data policies in Terms & Conditions, Privacy Policy. You can also find out how we use your data to power services on your device and protect your privacy in Privacy Centre.

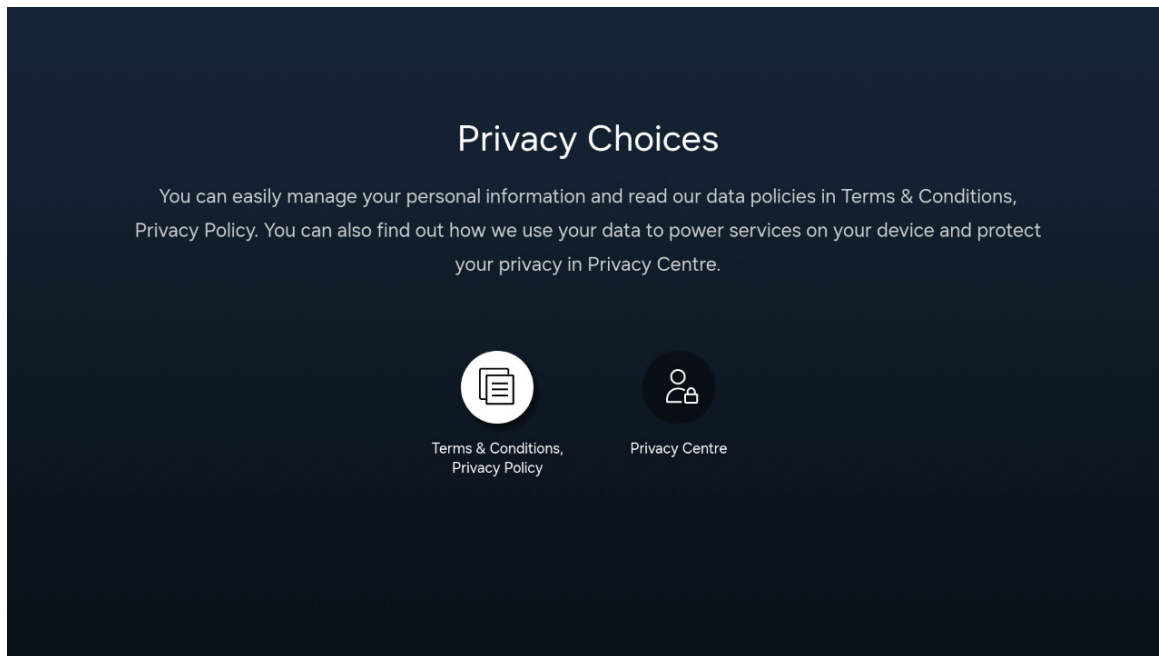

# SEARCH

Press to select Search, then press <OK> to enter.

You can search for channels, programs, movie titles and apps from Smart Hub.

(Note:It only available when connected to the Internet.)

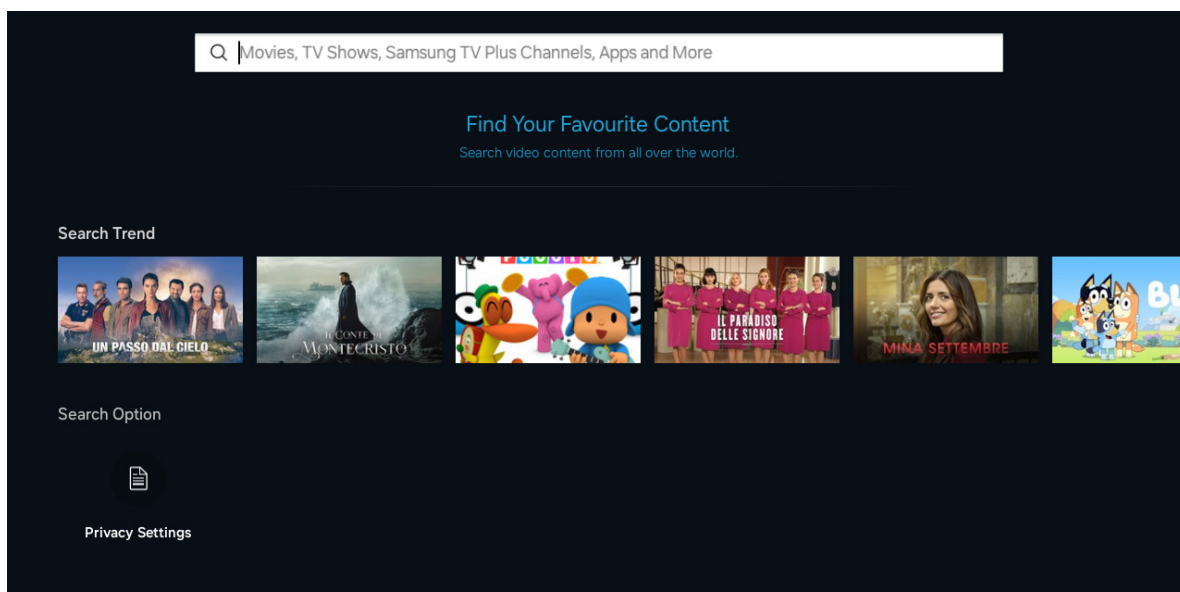

# GAMING HUB

This is the Gaming hub available on all Tizen OS TVs.

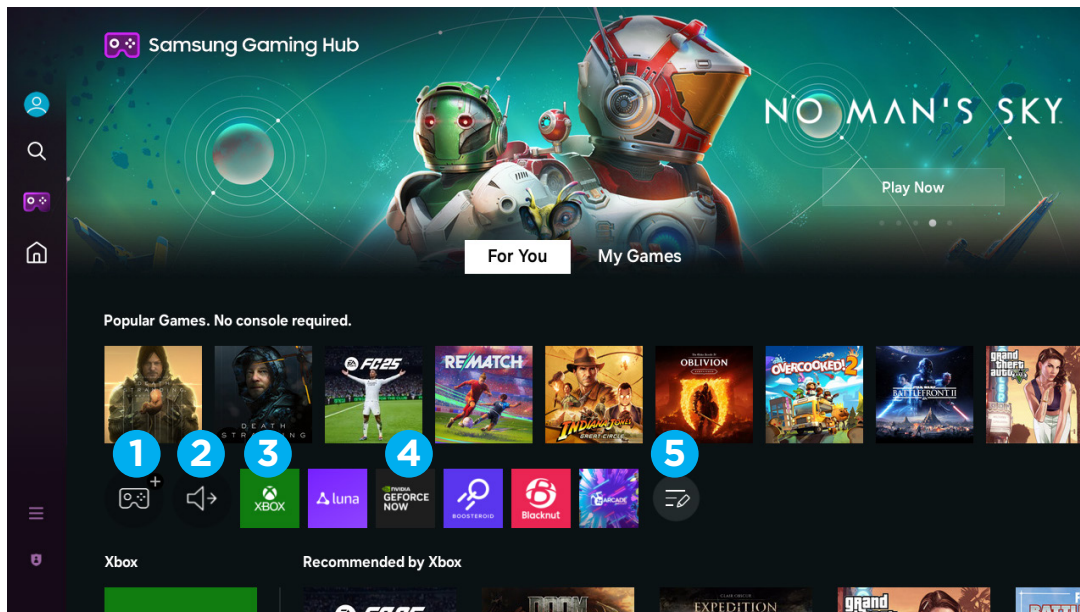

The home dashboard is your central hub for gaming such as cloud streaming and installing games from the app store.

You can connect gaming accessories such as mouse, keyboard or controllers via Bluetooth.

1. Accessories via Bluetooth
2. Volume Control
3. XBOX app - Pre-installed
4. NVidia GeForce Now - Available through App Store.
5. Edit Apps.

# MEDIA

Press to select Media, then press <OK> to enter.

You can also press to select Connected Devices on Source mode on the home page.

Play media content stored on your TV, USB devices, mobile devices, cameras, PCs, etc.



# SOURCE (INPUTS)

Press to select Connected Devices, then press <OK> to enter. You can select an external device connected to the TV.

(Optional:TV/HDMI1/HDMI2/HDMI3/AV/Connection Guide)

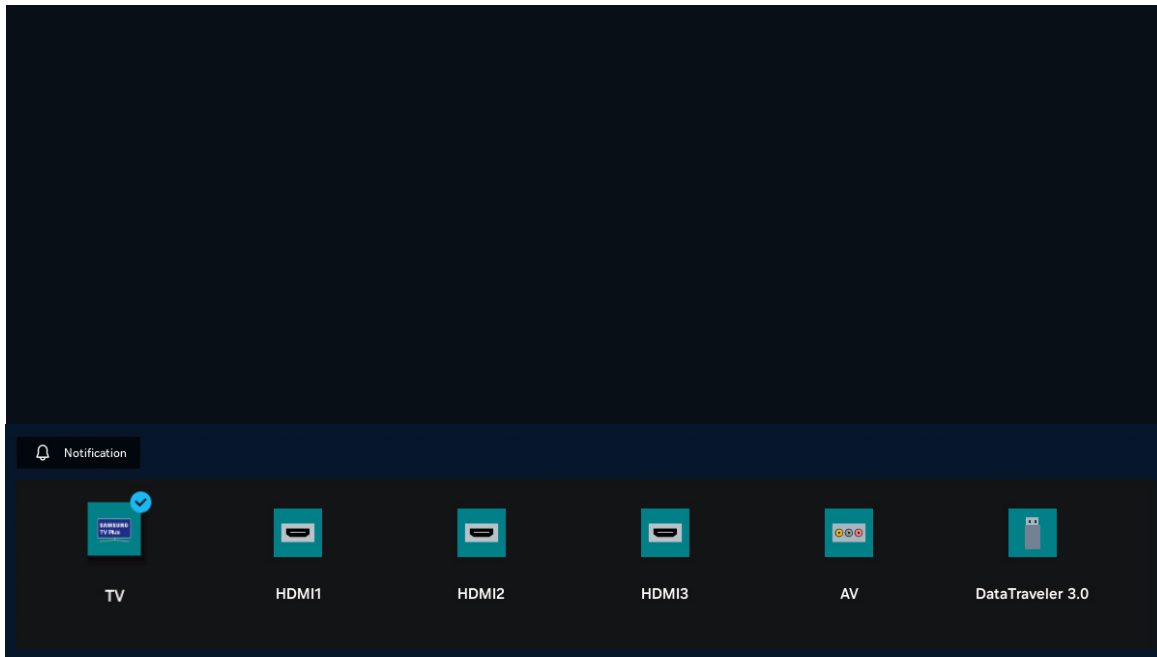

# SETTINGS

Press to select Connected Devices, then press <OK> to enter. (Optional: Sound Output/Backlight/Picture Mode/Sound Mode/Energy Saving Solution/Bluetooth Devices/Wi-Fi/Sleep Timer/Game Mode/Power and Energy Saving/Subtitle/Audio Language/Digital Output Audio Format/Contrast Enhancer/Colour Tone/Picture Size/Support).

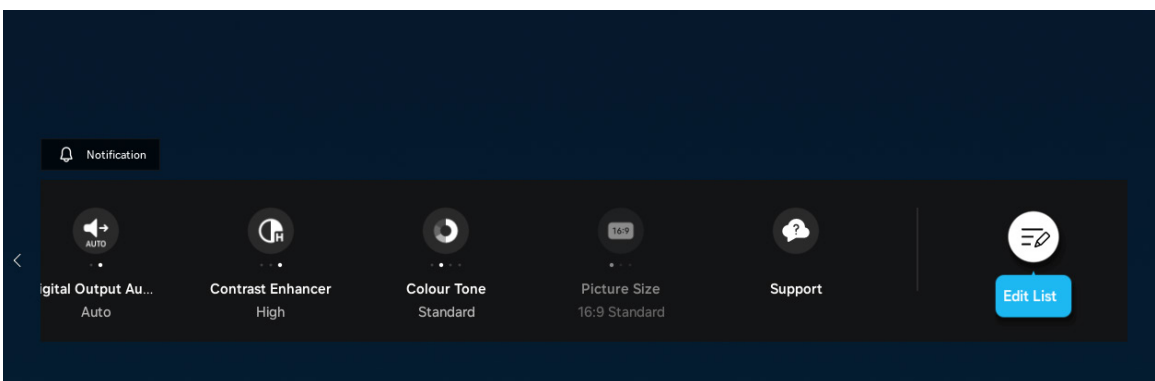
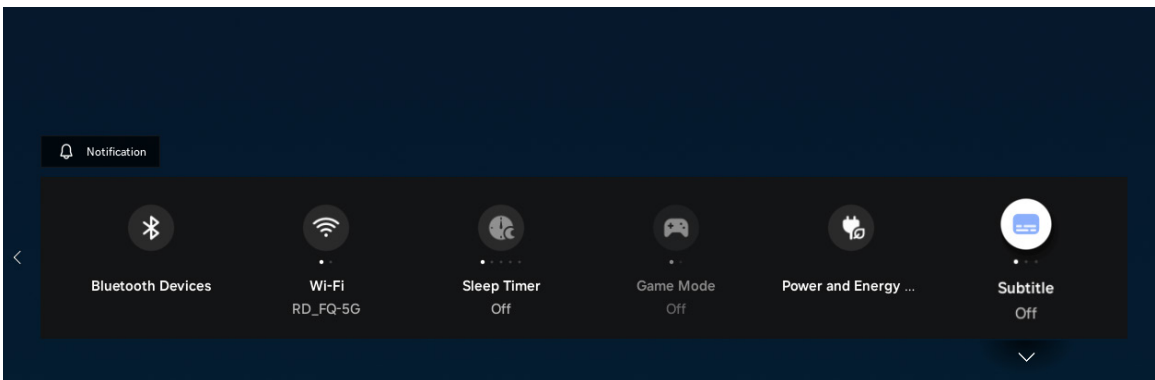
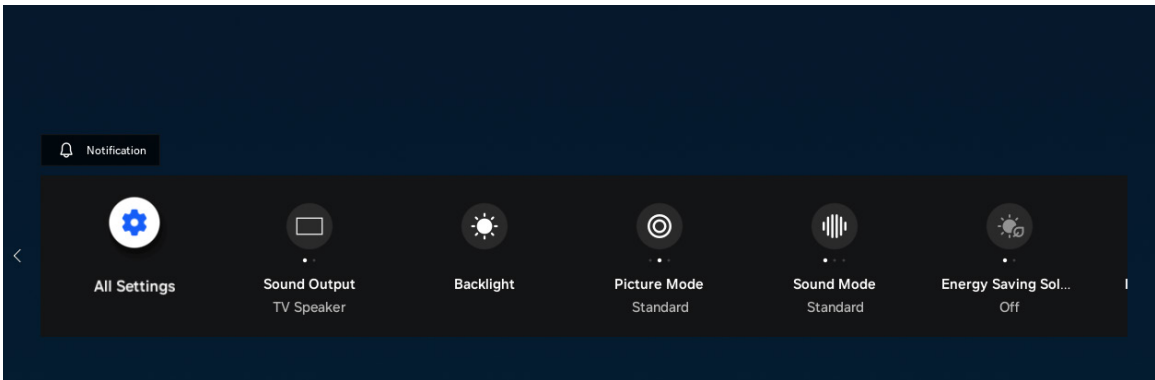

# APPS

Press to select Apps, then press <OK> to enter.

You can enjoy a wide range of contents including news, sports, weather and games by installing the corresponding apps on your TV.

(Note:It only available when connected to the Internet.)

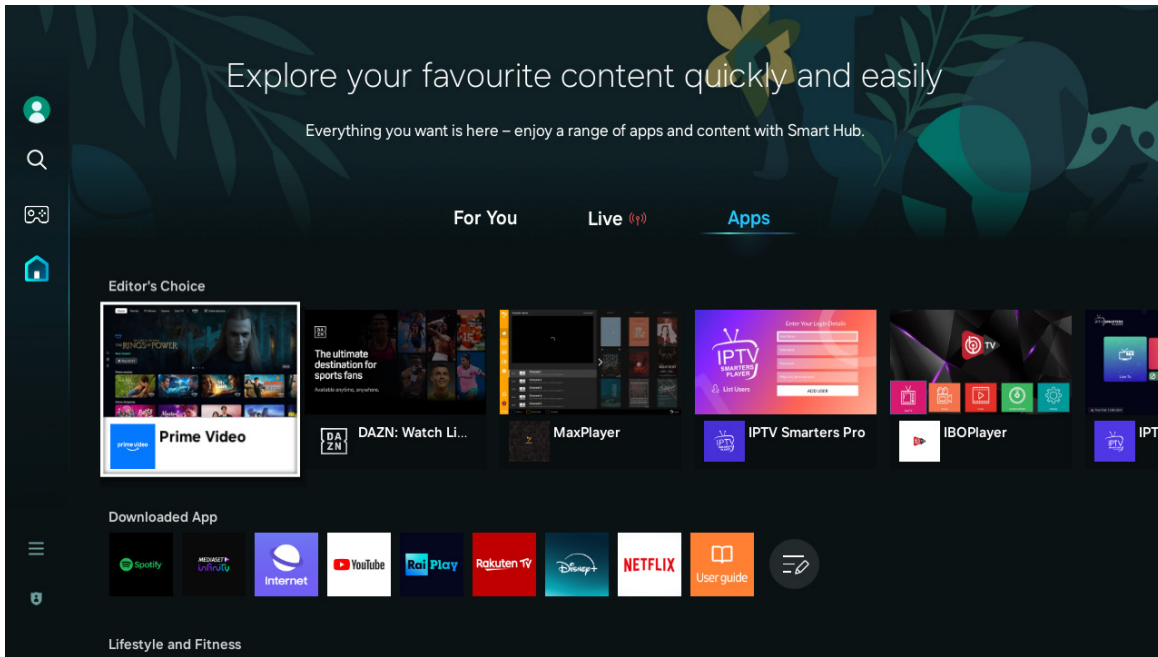

# SETTINGS

## MENU

Press to highlight the desired menu icon , and press OK button to select. (Optional:Picture/  
Sound/Connection/Broadcasting/General&Privacy/Support)

## PICTURE

Press MENU button to enter the main menu.

Press to select the Picture.

Press OK button to enter the sub-menu.

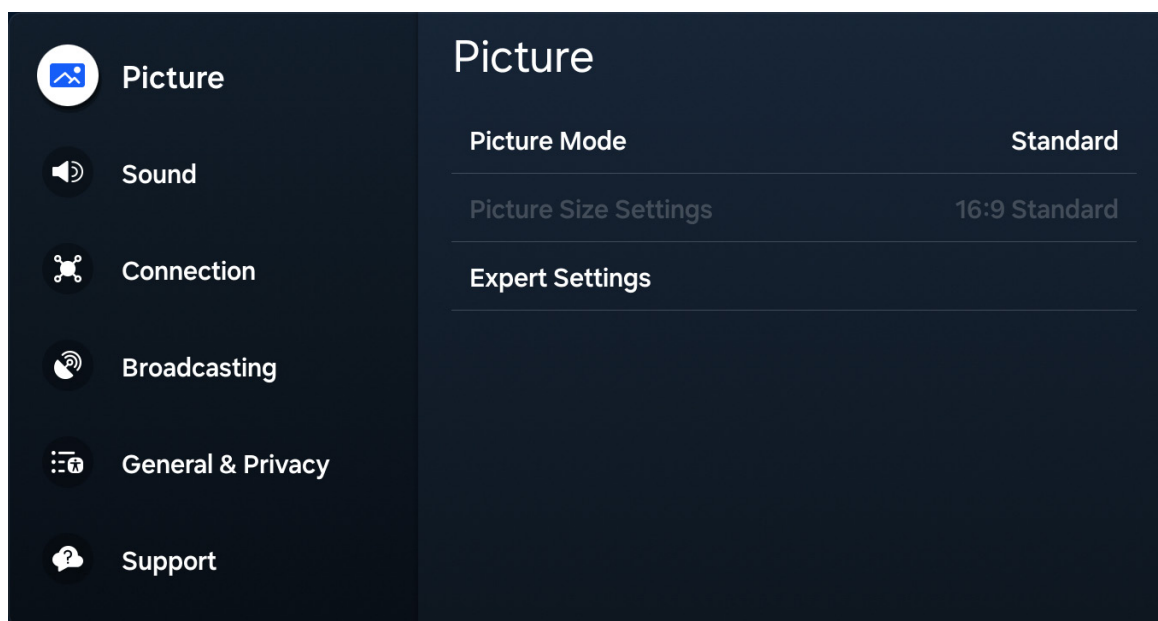

# SETTINGS (Cont.)

## SOUND

Press MENU button to enter the main menu.

Press to select the Sound.

Press OK button to enter the sub-menu.

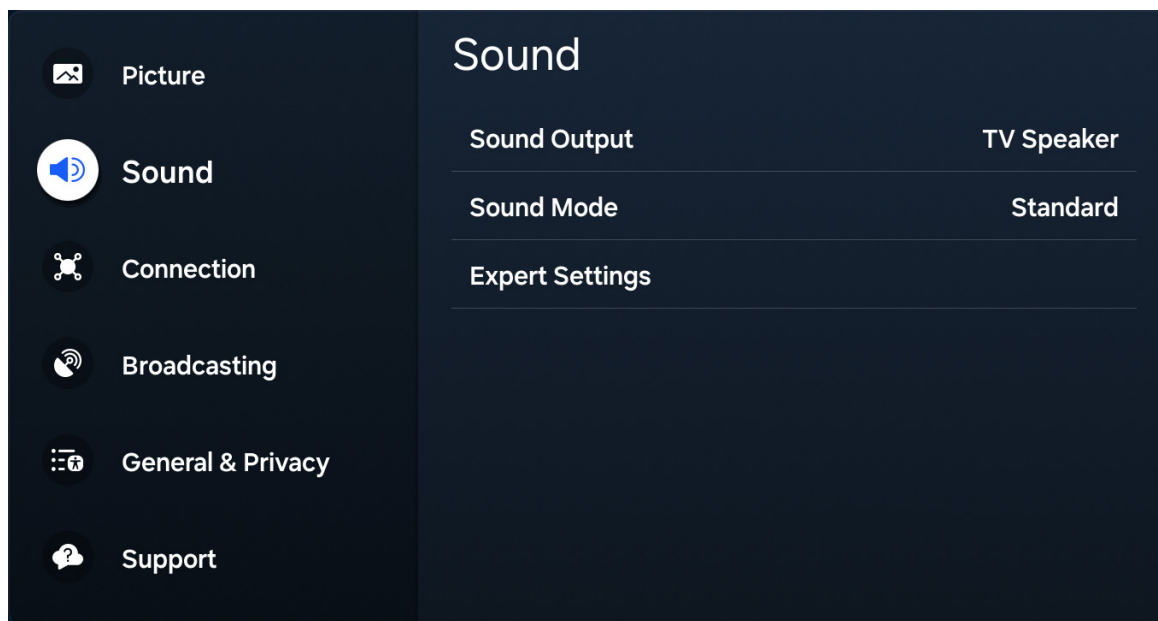

# SETTINGS (Cont.)

## Connection

Press MENU button to enter the main menu.

Press to select the Connection.

Press OK button to enter the sub-menu.

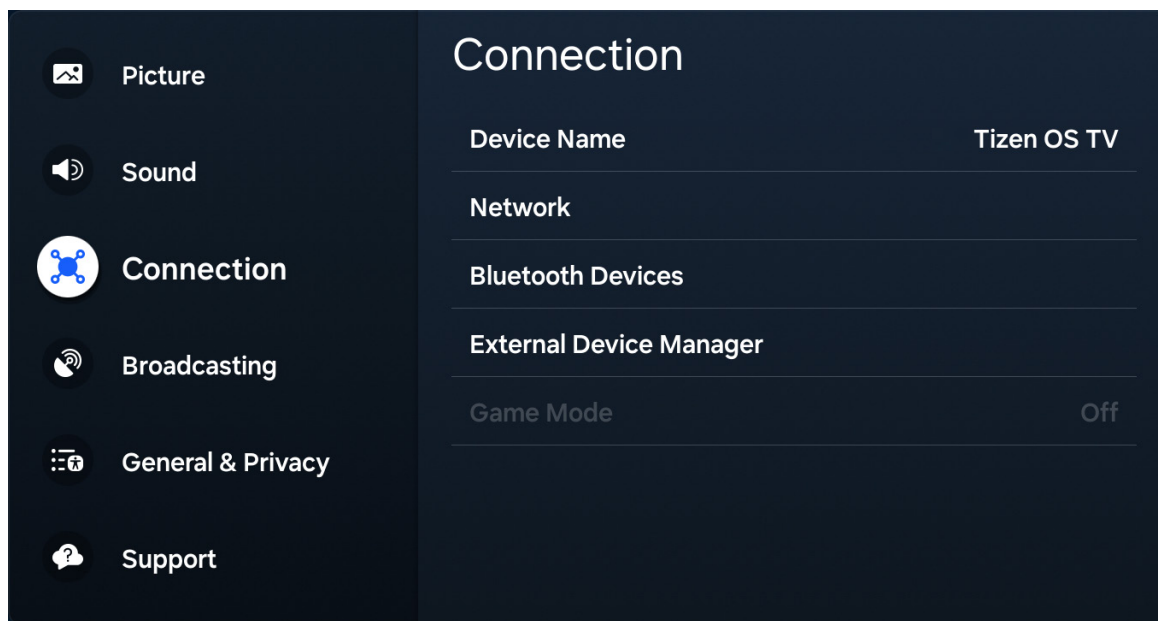

# SETTINGS (Cont.)

## BROADCASTING

Press MENU button to enter the main menu.

Press to select the Broadcasting.

Press OK button to enter the sub-menu.

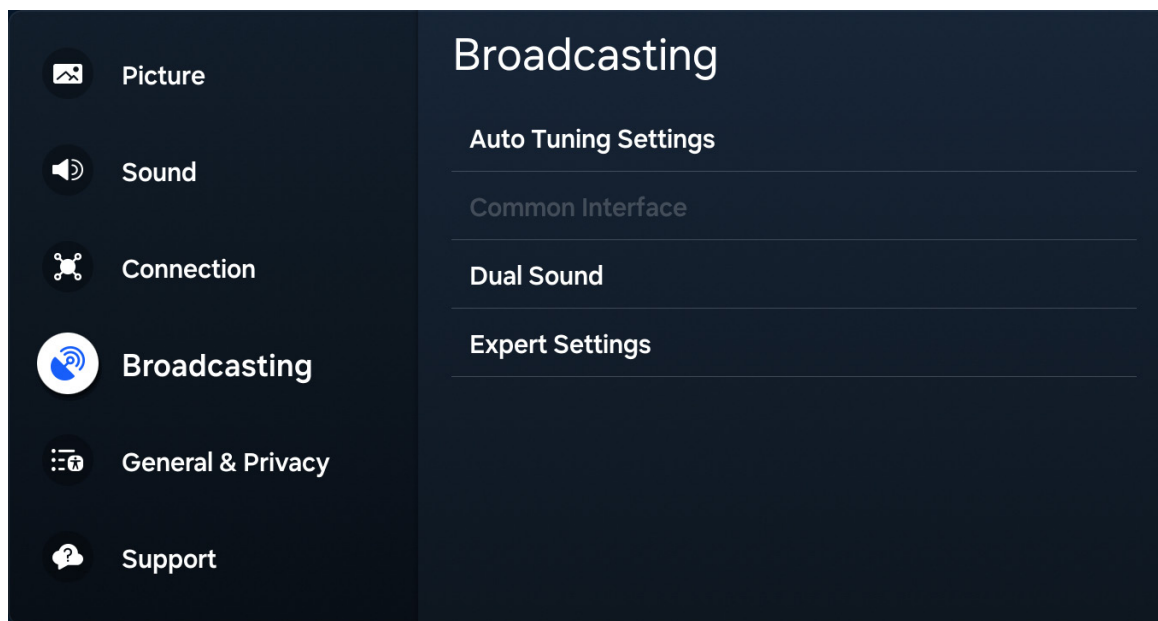

# SETTINGS (Cont.)

## GENERAL & PRIVACY

Press MENU button to enter the main menu.

Press to select the General & Privacy.

Press OK button to enter the sub-menu.

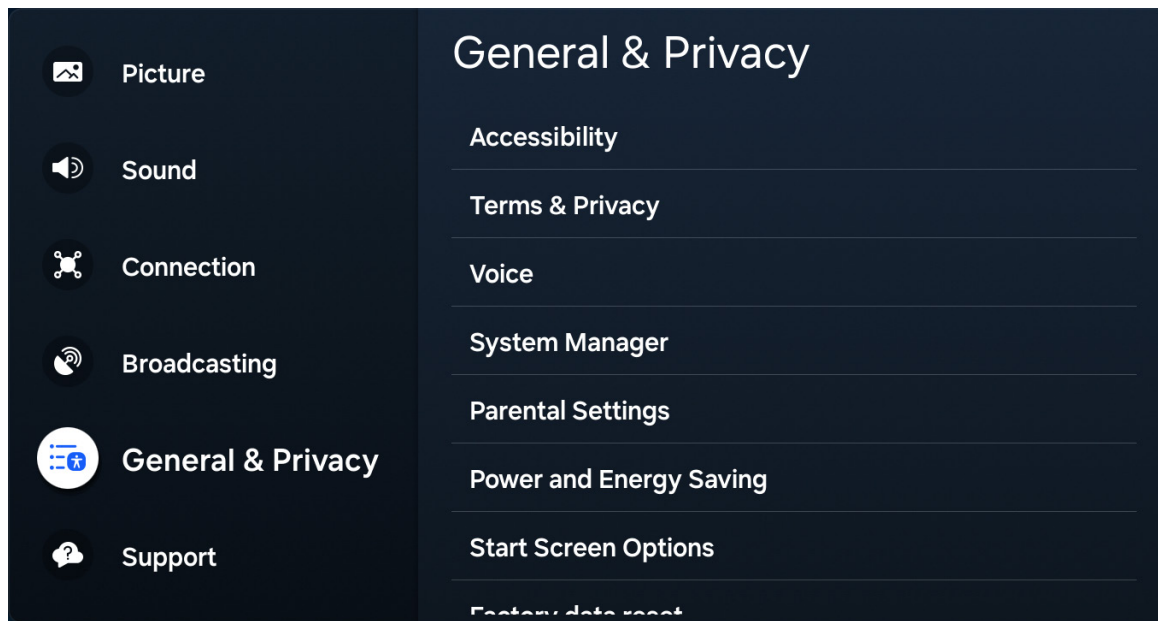

# SETTINGS (Cont.)

## SUPPORT

Press MENU button to enter the main menu.

Press to select the Support.

Press OK button to enter the sub-menu.

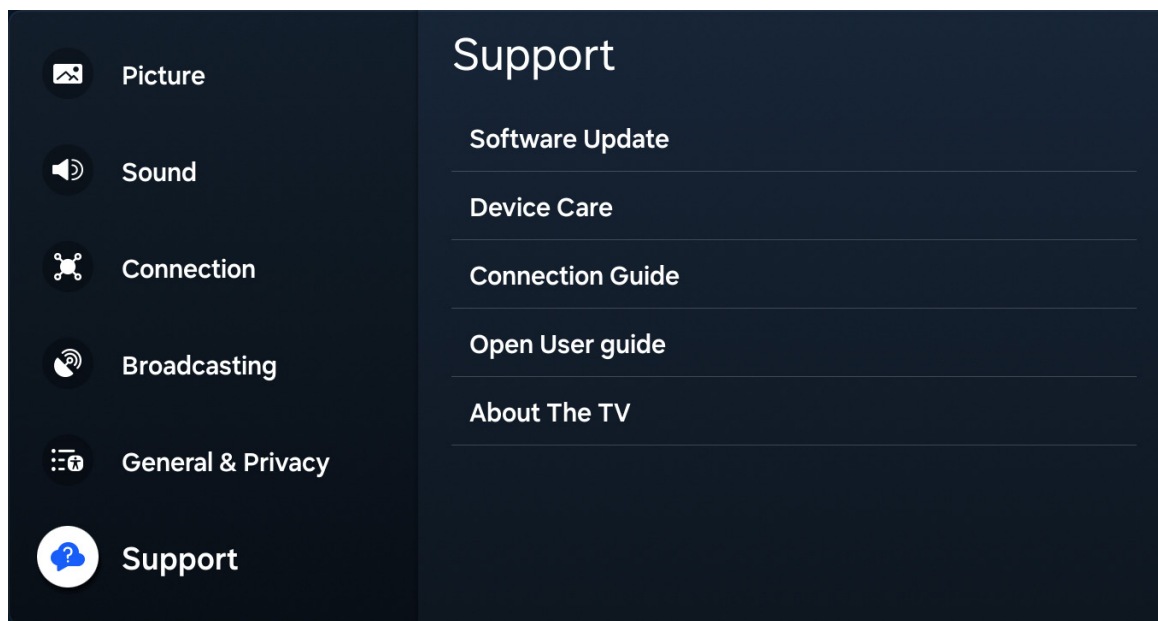

# FAQs

## GENERAL PROBLEMS WITH TV SET

Many minor issues can be resolved by hard resetting, power cycling the unit or upgrading the firmware.

### **To perform a hard reset, or power cycle, please use the following steps.**

- Unplug it from the main power socket and leave it for 10-15 mins
- Press and hold power button on the TV for 5 seconds.
- Connect the TV back to the power and turn it back on.

### **USB device is not recognised.**

- Ensure the drive is formatted for FAT32 before using with this TV.  
Use a computer to format the drive beforehand.

### **Poor picture and sound quality.**

- Try a different channel
- Adjust the antenna
- Check all connections

### **No sound or sound is too low at maximum volume.**

- Check the volume settings on any external speakers connected to your television.
- Check another channel or input.
- Check that MUTE hasnt been turned on.

### **No colour, wrong colour or tints**

- Make sure the program itself is broadcast in colour
- Select the picture menu, then adjust the colour and tint submenus.

### **Picture rolls vertically**

- Check all connections

### **Blurred or snowy picture, distorted sound.**

- Check direction, locations and connections to your antenna
- Issues may be caused by the use of an indoor antenna (poor signal)

# FAQs (Cont.)

## **Remote control malfunctions.**

- Replace the batteries
- Check battery polarities (+/-) and that battery is inserted correctly.
- Remote is out of range
- Remove any obstructions between remote and IR sensor.
- Make sure the power cord to your TV is turned on and plugged in.

## **Image is not centred in the screen**

- Adjust the horizontal and vertical position.

## **“No signal” on hdmi source**

- Test the device with a different HDMI port or cable.
- Try a different device connected to the same cable and port.
- Perform a factory reset on your TV.

For any further questions, please contact our support center.

## Italiano



### Trattamento del dispositivo elettrico od elettronico a fine vita (Applicabile in tutti i paesi dell'Unione Europea e in quelli con sistema di raccolta differenziata)

Il simbolo del cassonetto barrato riportato sull'apparecchiatura indica che il prodotto alla fine della propria vita utile deve essere raccolto separatamente dagli altri rifiuti. L'utente dovrà pertanto conferire l'apparecchiatura integra dei componenti essenziali giunta a fine vita agli idonei centri di raccolta differenziata dei rifiuti elettronici ed elettrotecnici, oppure riconsegnarla al rivenditore al momento dell'acquisto di nuova apparecchiatura di tipo equivalente, in ragione di uno a uno, oppure 1 a zero per le apparecchiature aventi lato maggiore inferiore a 25cm.

Assicurandovi che questo prodotto sia smaltito correttamente, voi contribuirete a prevenire potenziali conseguenze negative per l'ambiente e per la salute che potrebbero altrimenti essere causate dal suo smaltimento inadeguato. Il riciclaggio dei materiali aiuta a conservare le risorse naturali. Per informazioni più dettagliate circa il riciclaggio di questo prodotto, potete contattare l'ufficio comunale, il servizio locale di smaltimento rifiuti oppure il negozio dove l'avete acquistato.

Chiunque abbandona o cestina questo apparecchio e non lo riporta in un centro di raccolta differenziata per rifiuti elettrici-elettronici è punito con la sanzione amministrativa pecuniaria prevista dalla normativa vigente in materia di smaltimento abusivo di rifiuti di cui al D.Lgs n. Decreto Legislativo N°49 del 14 Marzo 2014.

## English



### Disposal of old electrical & electronic equipment (Applicable in the European Union and other European countries with separate collection systems)

This symbol on the product or in its packaging indicates that this product shall not be treated as household waste. Instead it shall be handed over to the applicable collection point for the recycling of electrical and electronic equipment. By ensuring this product is disposed of correctly, you will help prevent potential negative consequences for the environment and human health, which could otherwise be caused by inappropriate waste handling of this product. The recycling of materials will help to conserve natural resources. For more detailed information about recycling of this product, please contact your local city office, your household waste disposal service or the shop where you purchased the product.

## Français



### Traitement des appareils électriques et électroniques en fin de vie (Applicable dans les pays de l'Union Européenne et aux autres pays européens disposant de systèmes de collecte sélective)

Ce symbole, apposé sur le produit ou sur son emballage, indique que ce produit ne doit pas être traité avec les déchets ménagers. Il doit être remis à un point de collecte approprié pour le recyclage des équipements électriques et électroniques. En s'assurant que ce produit est bien mis au rebus de manière appropriée, vous aiderez à prévenir les conséquences négatives potentielles pour l'environnement et la santé humaine. Le recyclage des matériaux aidera à conserver les ressources naturelles. Pour toute information supplémentaire au sujet du recyclage de ce produit, vous pouvez contacter votre municipalité, votre déchetterie ou le magasin où vous avez acheté le produit.

## Español



### Tratamiento de los equipos eléctricos y electrónicos al final de su vida útil (Aplicable en la Unión Europea y en países europeos con sistemas de recogida selectiva de residuos)

Este símbolo en su equipo o su embalaje indica que el presente producto no puede ser tratado como residuos domésticos normales, sino que deben entregarse en el correspondiente punto de recogida de equipos eléctricos y electrónicos. Asegurándose de que este producto es desechado correctamente, Ud. Está ayudando a prevenir las consecuencias negativas para el medio ambiente y la salud humana que podrían derivarse de la incorrecta manipulación de este producto. El reciclaje de materiales ayuda a conservar las reservas naturales. Para recibir información detallada sobre el reciclaje de este producto, por favor, contacte con su ayuntamiento, su punto de recogida más cercano o el distribuidor donde adquirió el producto.

## Deutsch



### Entsorgung von gebrauchten elektrischen und elektronischen Geräten (Anzuwenden in den Ländern der Europäischen Union und anderen europäischen Ländern mit einem separaten Sammelsystem für diese Geräte)

Das Symbol auf dem Produkt oder seiner Verpackung weist darauf hin, dass dieses Produkt nicht als normaler Haushaltsabfall zu behandeln ist, sondern an einer Annahmestelle für das Recycling von elektrischen und elektronischen Geräten abgegeben werden muss. Durch Ihren Beitrag zum korrekten Entsorgen dieses Produkts schützen Sie die Umwelt und die Gesundheit Ihrer Mitmenschen. Umwelt und Gesundheit werden durch falsches Entsorgen gefährdet. Materialrecycling hilft den Verbrauch von Rohstoffen zu verringern. Weitere Informationen über das Recycling dieses Produkts erhalten Sie von Ihrer Gemeinde, den Kommunalen Entsorgungsbetrieben oder dem Geschäft, in dem Sie das Produkt gekauft haben.

AYONZ LIMITED  
Unit 3 Cedar Court, 1 Royal  
Oak Yard London, SE1, 3GA  
Prodotto in China







  
**FERGUSON**

**CUSTOMER SUPPORT:**

info@ayonz.co.uk

**DISTRIBUTED BY:**

AYONZ LIMITED

Unit 3 Cedar Court, 1 Royal Oak Yard London, SE1, 3GA  
Bahnhofstr. 18, 85774 Unterföhring, Germany

